

G 4743
40196
T9606
T9986

T. 39 S. R. 19 & 20 E. W.M.

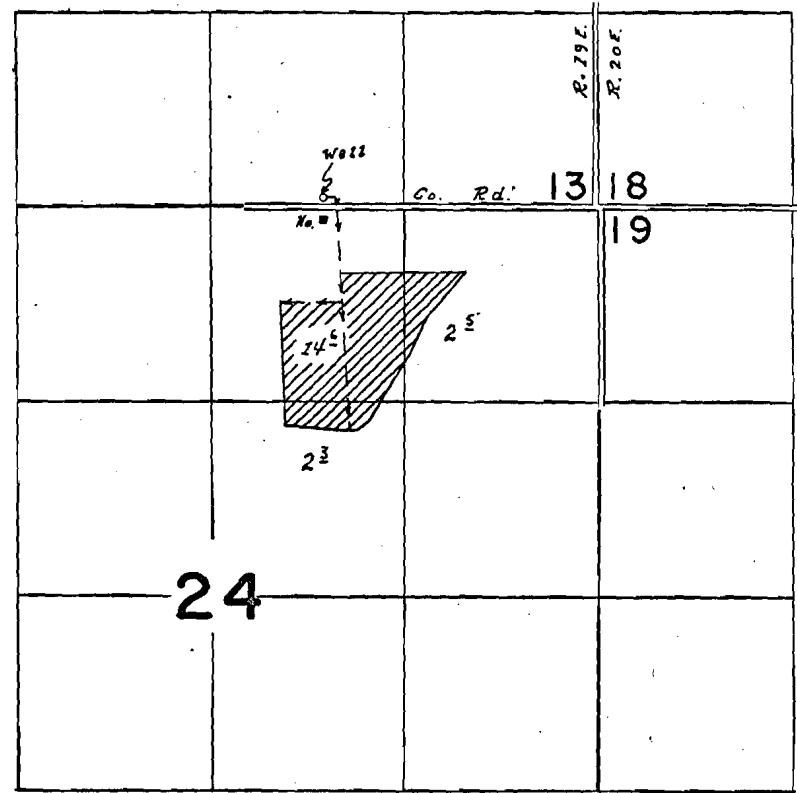

Well loc. 75' N. & 775' E. from S $\frac{1}{4}$ cor. Sec. 13

FINAL PROOF SURVEY
UNDER

Application No. G-5030 Permit No. G-4743
IN NAME OF

Elmo M. Angele

Surveyed 14 Sept. 1972, by L.E. Gould