

T.1N.R.2W.W.M.

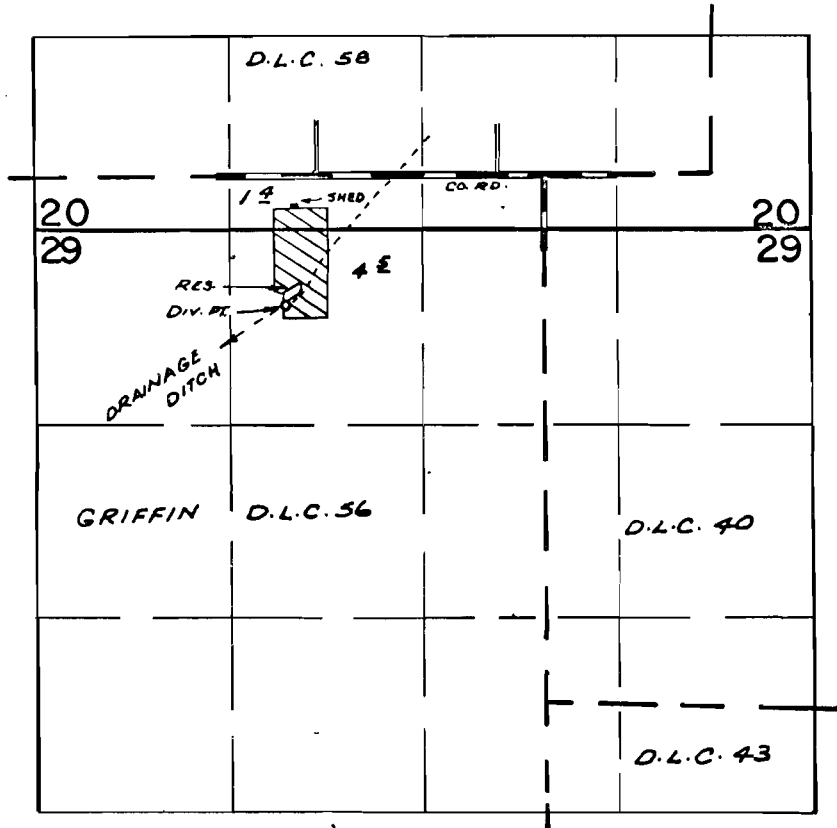

DIV. PTS. LOC: DITCH - 900'S. & 1760'W, RES. - 810'S. & 1720'W,
BOTH FROM N.W. COR. GRIFFIN D.L.C. 56

FINAL PROOF SURVEY UNDER

Application No. R-42317 42318 Permit No. R-4749 31272
IN NAME OF

RALPH W. MEEUWSEN

Surveyed SEPT. 26, 1972, by R. MUGGEN