

# T.I.S.R.2W.W.M.

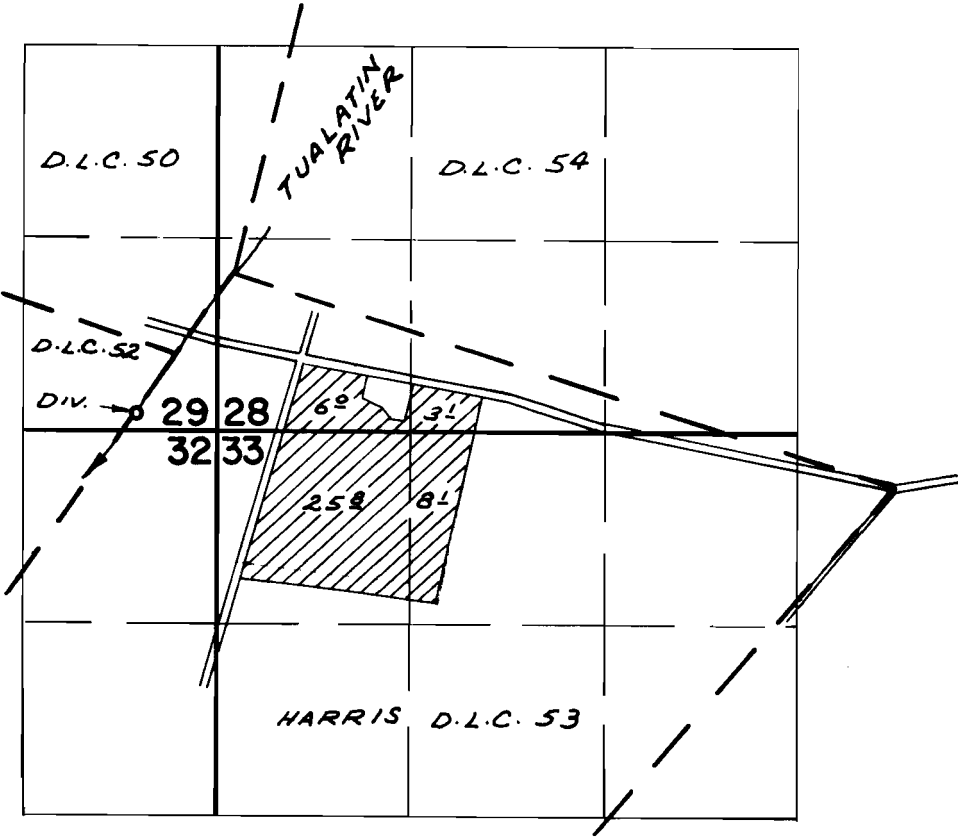

DIV. PT. LOC: 500' N. & 5170' W. FROM N.E. COR. HARRIS D.L.C. 53

## FINAL PROOF SURVEY UNDER

Application No. 26136... Permit No. 34468  
IN NAME OF

..... A. N. LUTTRELL .....

Surveyed Nov. 3 1972., by R. MUCKEN