

T.5 S., R.3 W., W.M.

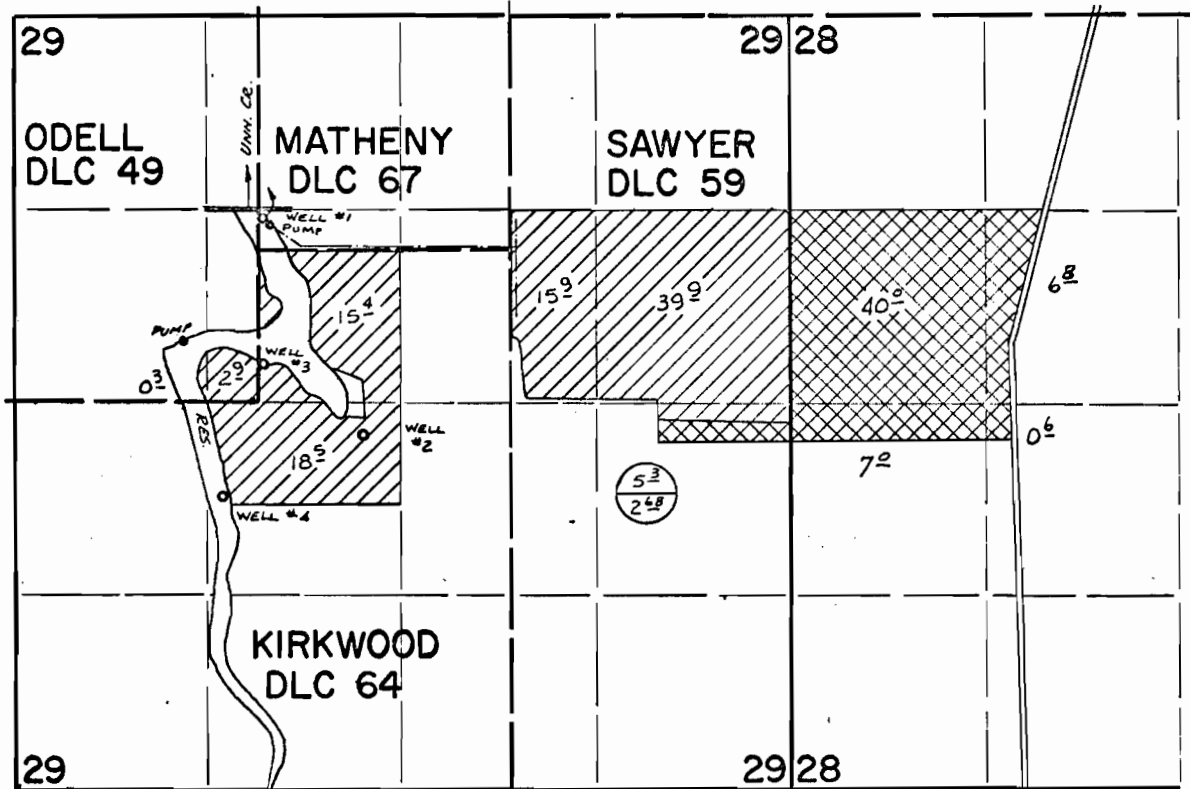

WELLS LOCATED: #1- 1260' N & 20' E; #2- 220' S & 720' E; #3- 260' N & 5' E;
 #4- 660' S & 235' W ALL FROM S.E. COR. ODELL D.L.C. 49
 DIK. PT. LOCATED: 1320' N & 80' W FROM S.E. COR. ODELL D.L.C. 49

FINAL PROOF SURVEY UNDER

R-46682 R-5610
 46683 34983
 Application No. G-3922 Permit No. G-3683
 IN NAME OF



ROBERT L. JANZEN

Surveyed March 26, 1973, by L.E. Gould