

T.3S., R.3W., W.M.

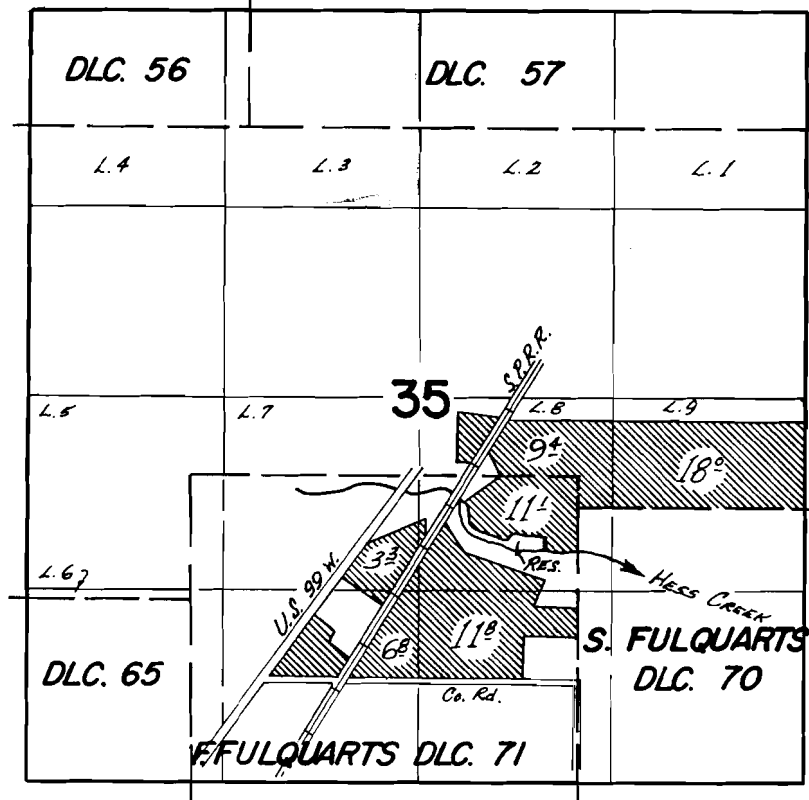

DIV. PT. LOC: 300'S. & 210'W. FROM N.W. COR.  
S. FULQUARTS D.L.C. 70

**FINAL PROOF SURVEY**  
UNDER

R-45219                      R-5334  
Application No. 45220 Permit No. 33777  
IN NAME OF  
RALPH DUNFORD

Surveyed May 17, 1973, by D. Norby