

T.4S. R.1W. W.M.

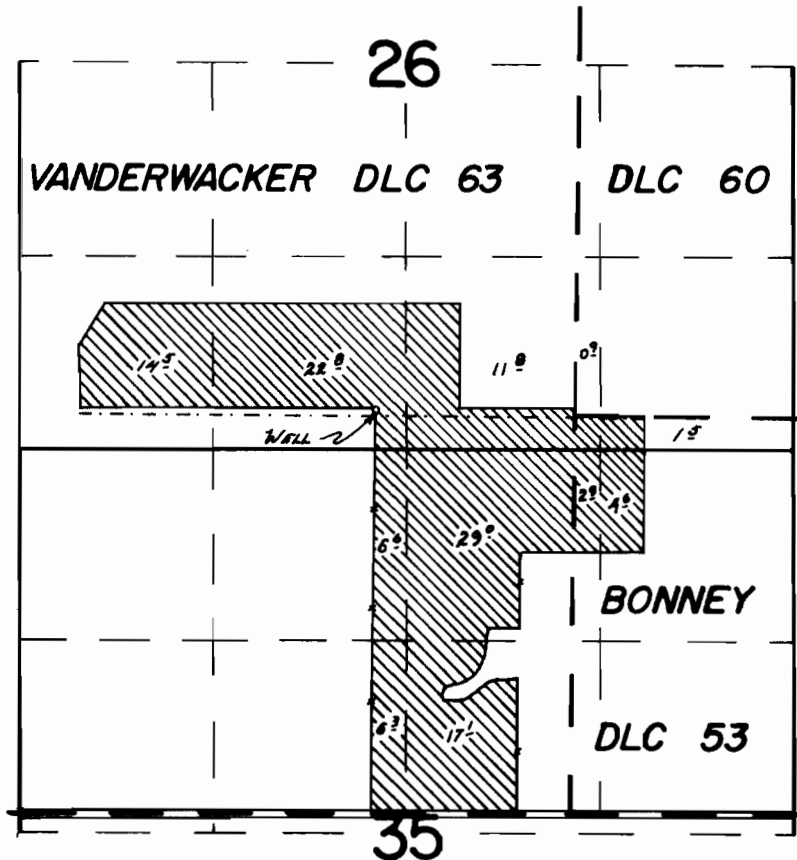

WELL LOC. 30' N & 1360' W FROM NW COR. BONNEY DLC 53

**FINAL PROOF SURVEY**  
UNDER

Application No. G-3722 Permit No. G-3518  
IN NAME OF

NORMAN STAUFFER

Surveyed MAY 22 1973, by T. J. PAUL