

T.7S. R.38&4W. W.M.

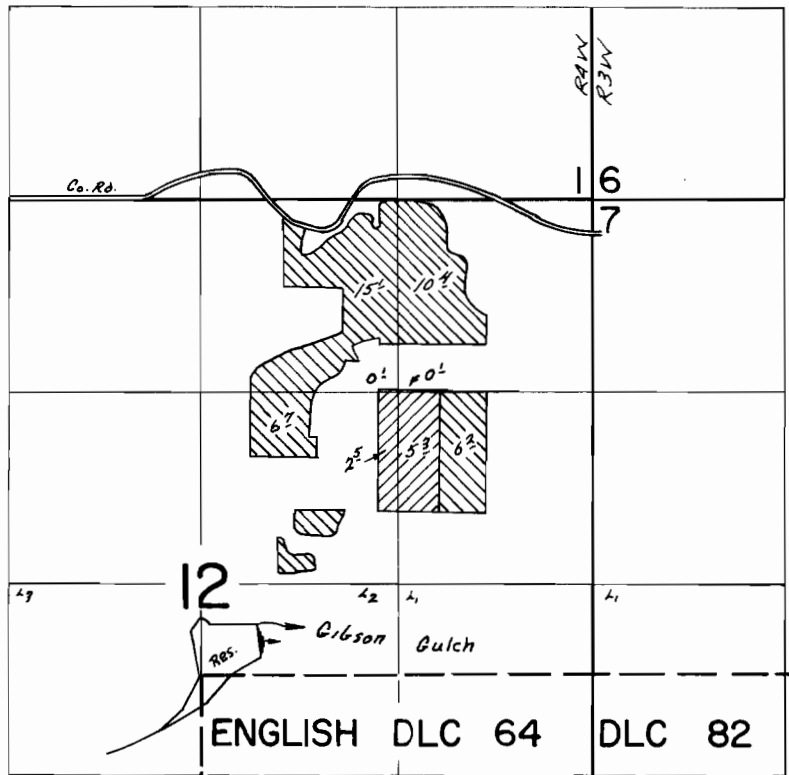

Dist. Pl. loc 400' S + 400' E From Center Sec 12

FINAL PROOF SURVEY UNDER

Transfer No. 2439

Application No. 47455 Permit No. 35403

IN NAME OF

REX V. L. & DUANE GIBSON

Surveyed April 6, 1973, by R.G. Mucken

