

T.6S., R.38E., W.M.

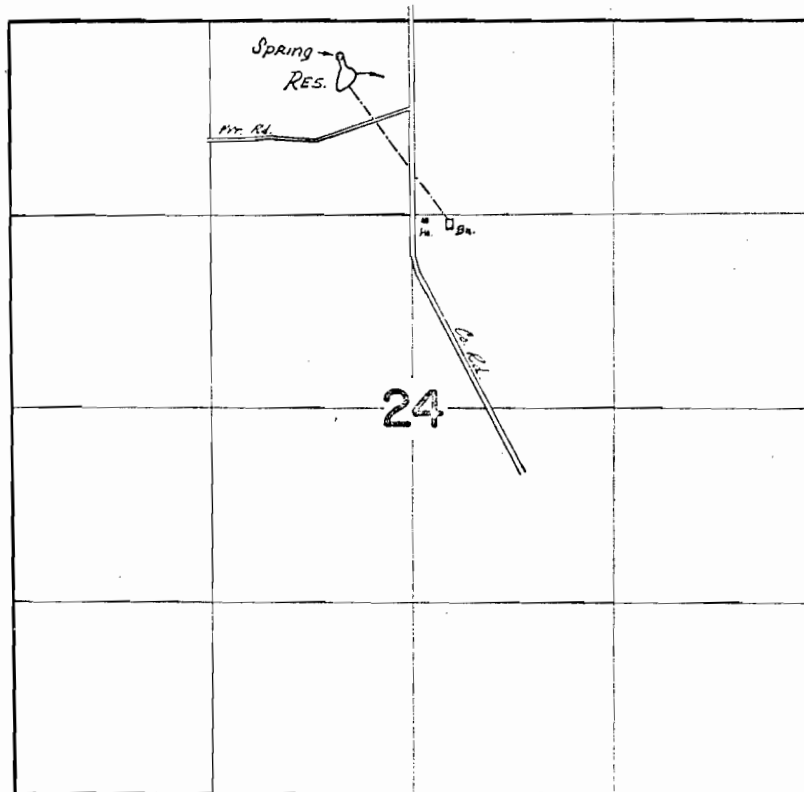

DIV. PT. LOC: 370'S. & 380'W. FROM N $\frac{1}{2}$ COR. SEC. 24

FINAL PROOF SURVEY
UNDER

R-44135 R-5092
Application No. 44136 Permit No. 32963
IN NAME OF

HENRY C. SCHWABROW

Surveyed July 16, 1913, by D. NORBY