

T.6S.,R.38E.,W.M.

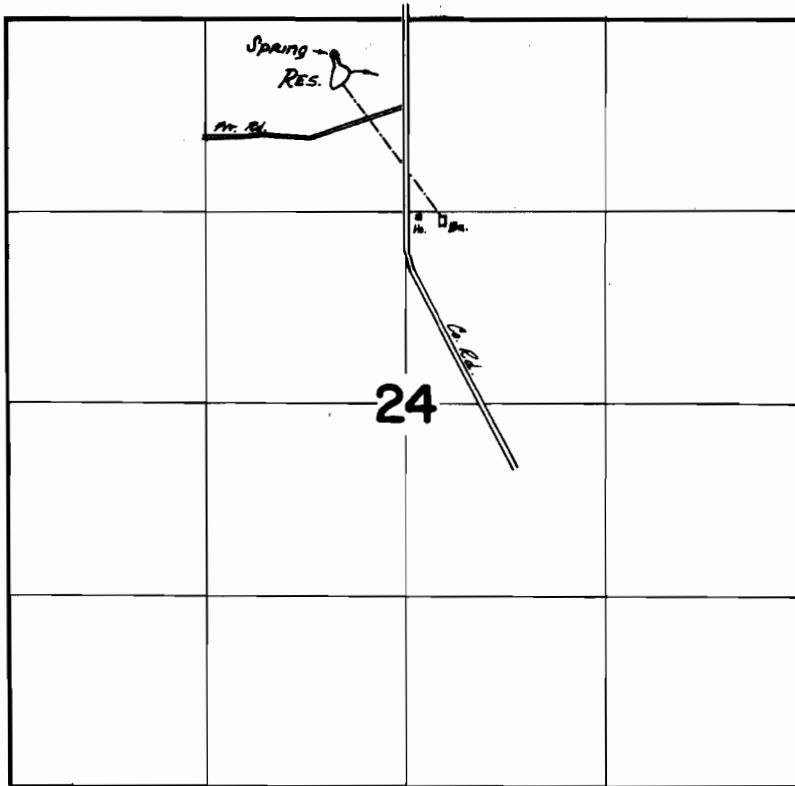

DIV. PT. LOC: 370'S. & 390' W. FROM N  $\frac{1}{4}$  COR. SEC. 24

**FINAL PROOF SURVEY**  
UNDER

R-44135                      R-5092  
Application No. 44136    Permit No. 32963  
IN NAME OF

HENRY C. SCHWABROW

Surveyed July 16 1973, by D. NORBY