

T.5S. R.5W. W.M.

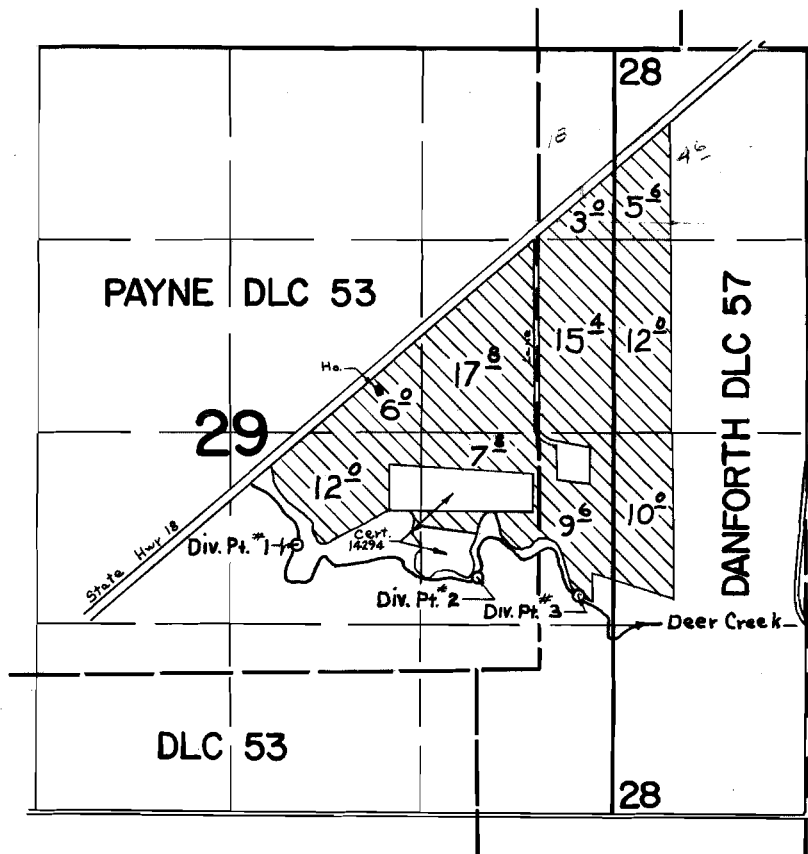

Div. Pts. Loc: #1 - 3420'S. & 3500'W., #2 - 3640'S. & 2250'W.,
#3 - 3770'S. & 1550'W. all from S'LY NE cor. Danforth DLC 57

FINAL PROOF SURVEY
UNDER

Application No. 44076 Permit No. 32990
IN NAME OF
HAROLD BUEL

Surveyed MAY 31, 1973, by R. G. MUCKEN