

T.4S., R.2W., W.M.

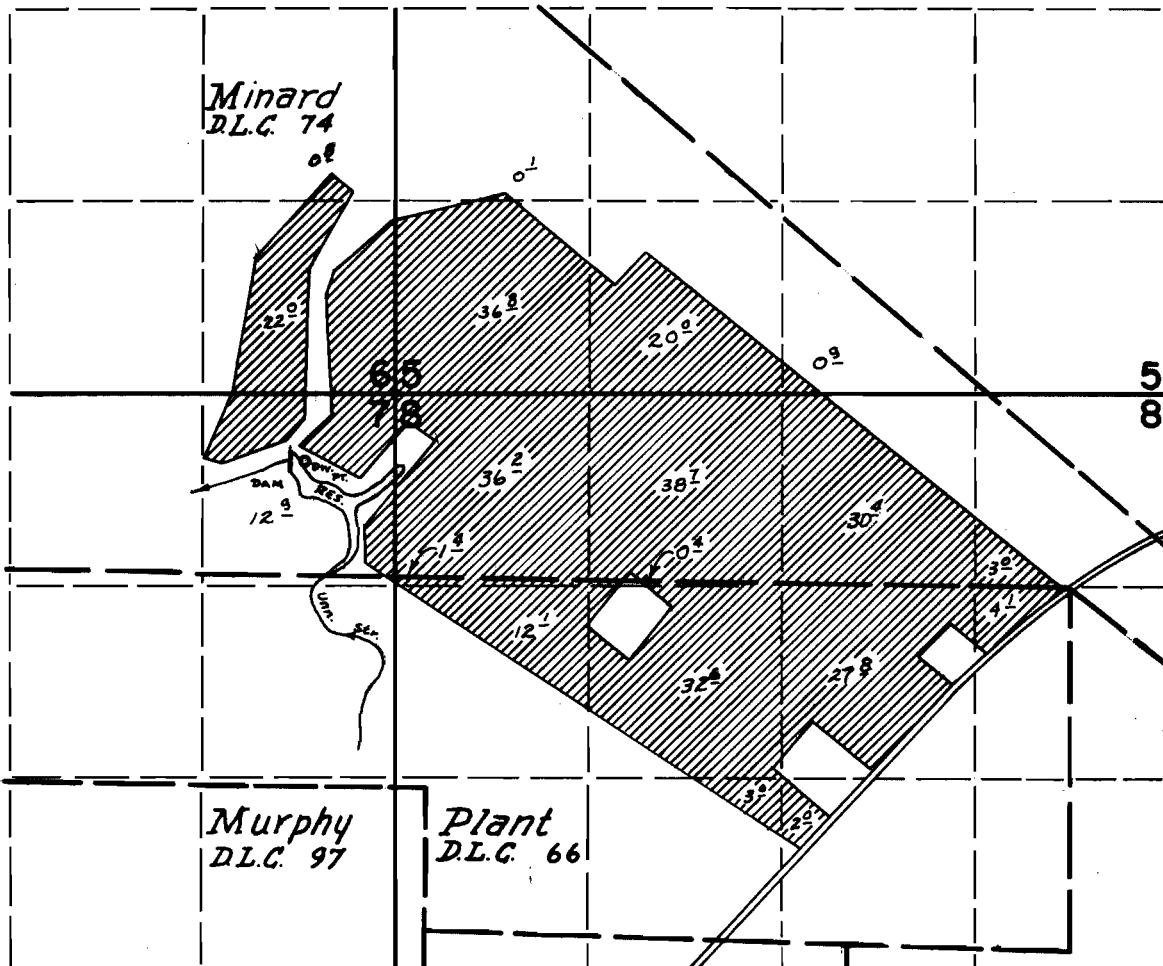

DAN LOCATED: 2250' N & 940' W FROM NE COR. MURPHY DLC 97
DIV. PT. LOCATED: 2250' N & 820' W FROM NE COR. MURPHY DLC 97

FINAL PROOF SURVEY

UNDER

R-43600

43601

R-44845

R-4928

32251

R-5102

Application No. 44846 Permit No. 32999

IN NAME OF

NELSON C. & HOWARD O. TRIBBETT
(dba: Tribbett & son)

Surveyed Oct. 3 1972, by D. Norby