

T.9S.R.3W.W.M.

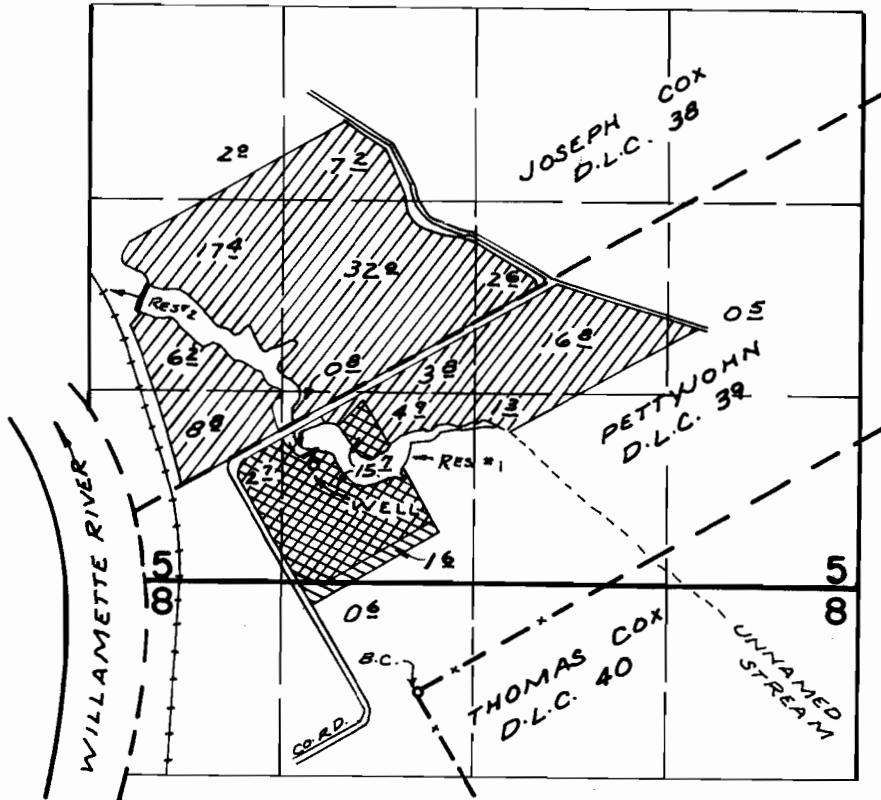

DIV. PTS. LOC: WELL - 1570' N & 720' W.; RES. - 1730' N. & 810' W., BOTH FROM N.W. COR. THOMAS COX D.L.C. 40

FINAL PROOF SURVEY UNDER

G-4057	G-3804	
R-45292	R-5249	
Application No. <u>45292</u>	Permit No. <u>32227</u>	
IN NAME OF		

..... JAMES L. PAYNE

Surveyed JULY 28, 1968, by V. GARNER
OCT. 27, 1972 R. MUCKEN