

T. 1 N., R. 4 W., W.M.

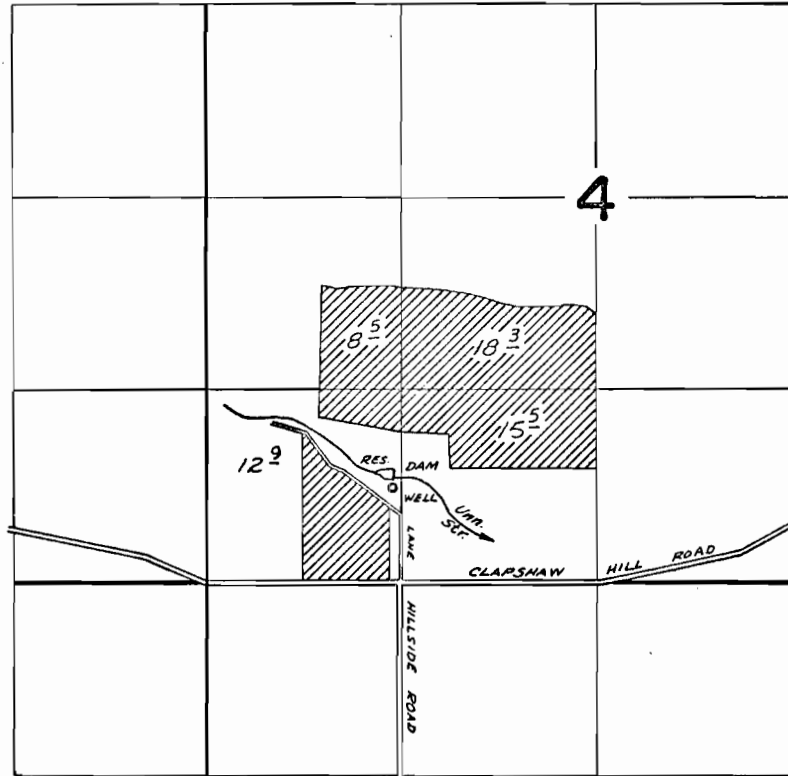

WELL LOCATED: 650' N & 60' W FROM SE COR. SW 1/4 SW 1/4 SEC. 4.
 DAM LOCATED: 730' N & 50' W FROM SE COR. SW 1/4 SW 1/4 SEC. 4.

FINAL PROOF SURVEY UNDER

R-44082 R-5254
 44083 33238
 Application No. G-4779 Permit No. G-4502
 IN NAME OF

DWAYNE E. HEIKES

Surveyed June 6 1972, by L. E. Gould