

# T. 1 N., R. 4 W., W.M.

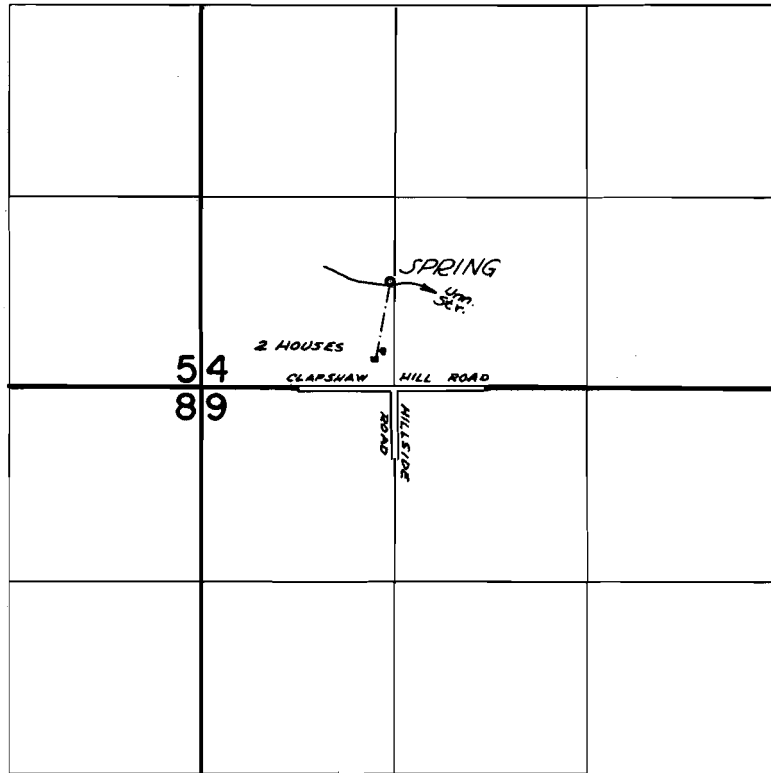

SPRING LOCATED: 730' N & 30' W FROM SE COR SW $\frac{1}{4}$  SW $\frac{1}{4}$  SEC 9.

## FINAL PROOF SURVEY UNDER

Application No. 43911 Permit No. 32818  
IN NAME OF

READ GREENWOOD

Surveyed June 7 1972, by L.E. Gould