

T. 2 N. R. 3 W. W. M.

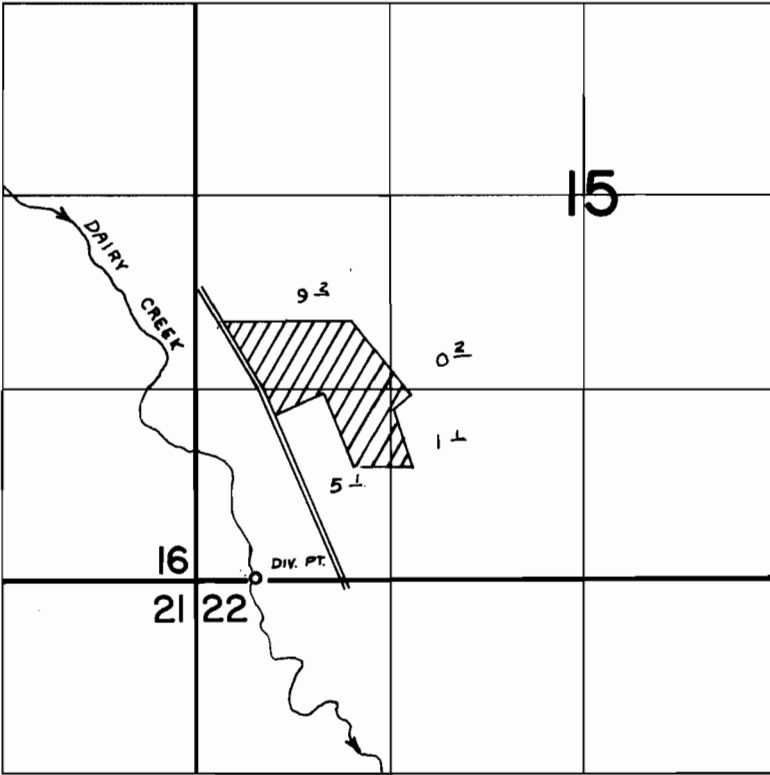

Div. Pt. Located 10' N & 2240' W From S 1/4 Cor. Sec. 15

**FINAL PROOF SURVEY**  
UNDER

Application No. 46533 Permit No. 34765  
IN NAME OF

MARTIN STADELMAN

Surveyed JUN 26 1973 by R.G. MUCKEN