

# T.1S., R.3W., W.M.

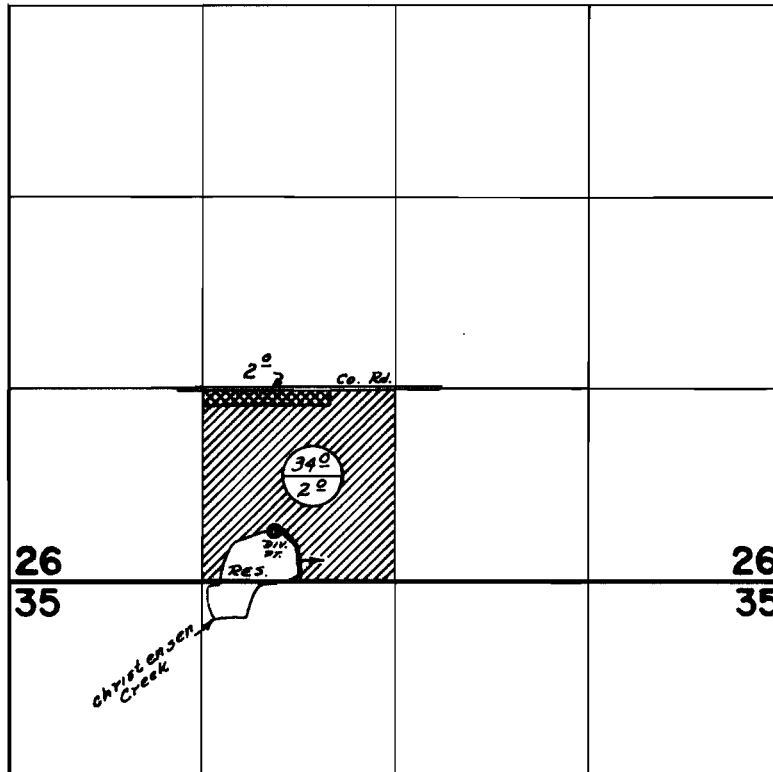

DIV. PT. LOCATED: 340' N & 830' W FROM 5/4 COR. SEC. 26.  
 140' N & 660' W FROM 5/4 COR. SEC. 26.

UNDER APP. #45394

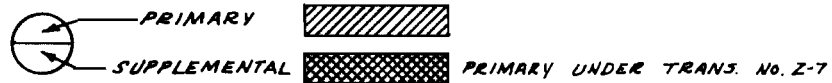

## FINAL PROOF SURVEY UNDER

Transfer No. Z-7

Application No. R-45226 45394 Permit No. R-5281 33410  
 IN NAME OF

ANDREW ZAGLOW

Surveyed June 14 1972, by D. Norby