

T.1S., R.3W., W.M.

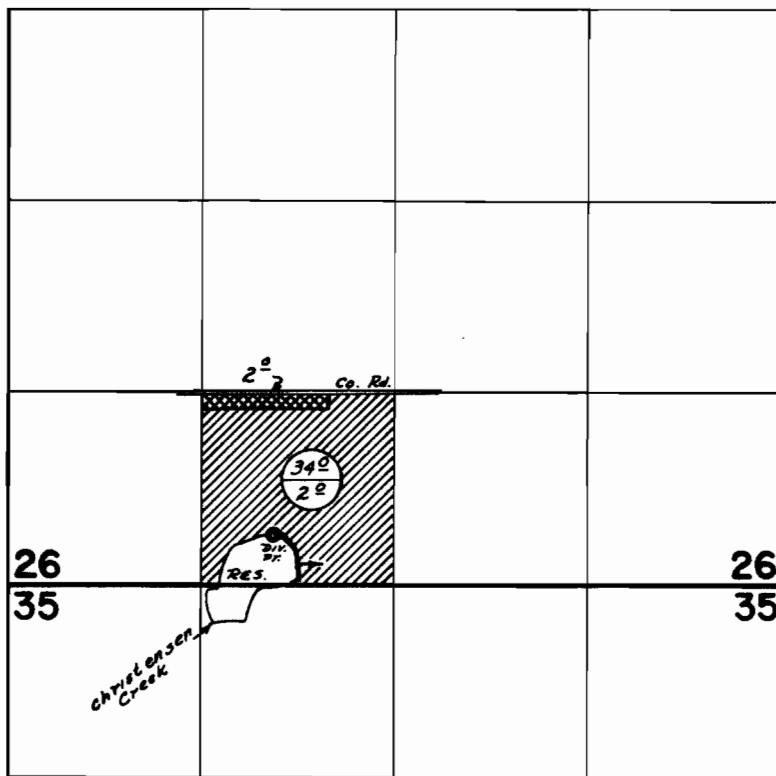

DIV. PT. LOCATED: 340' N & 830' W FROM 5/4 COR. SEC. 26.
140' N & 660' W FROM 5/4 COR. SEC. 26.

UNDER APP. #45334

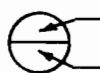

PRIMARY



SUPPLEMENTAL



PRIMARY UNDER TRANS. No. Z-7

FINAL PROOF SURVEY UNDER

Transfer No. Z-7

R-45226

R-5281

Application No. 45334 Permit No. 33410

IN NAME OF

ANDREW ZAGLOW

Surveyed June 14, 1972, by D. Norby