

T.20S. R.3W. W.M.

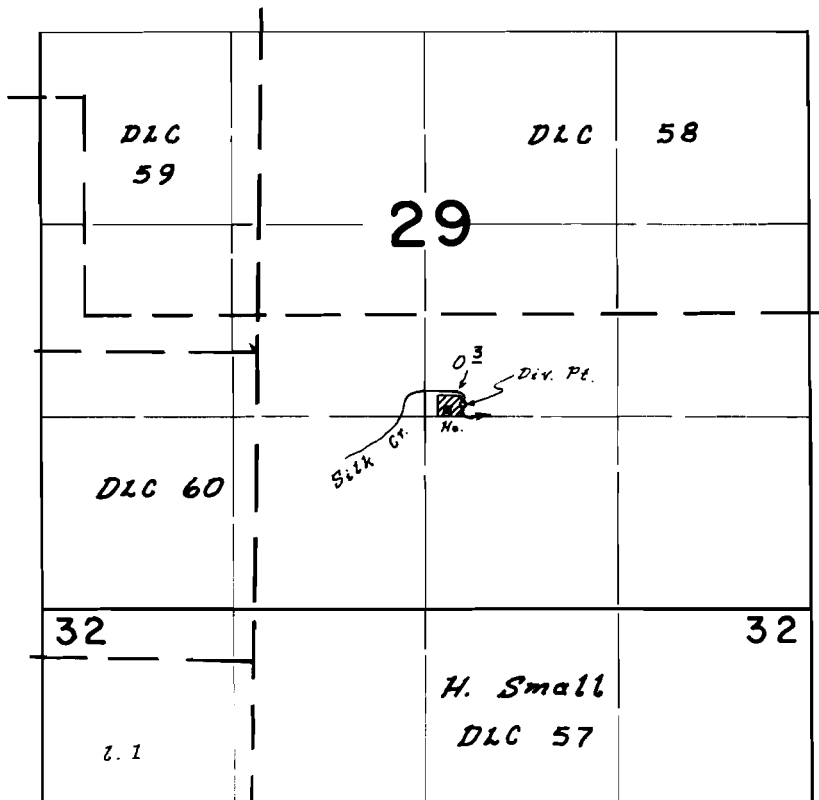

Div. Pt. 200.1420' N. of 260' E. from S. 1/2 cor. Sec. 29

FINAL PROOF SURVEY
UNDER

Application No 45833... Permit No 34290
IN NAME OF

George P. Bouche & Sharon F. Bouche

Surveyed 1 June... 1972, by L.E. Gould...