

T.10S., R.3W., W.M.

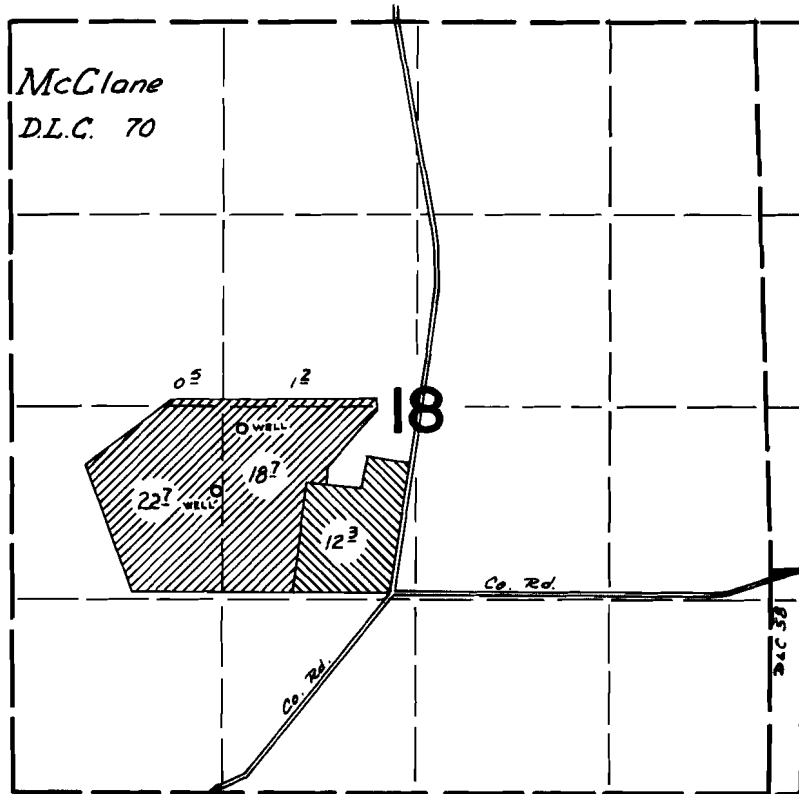

DIV. PTS. LOCATED: 2780' S & 3440' W FROM NE COR. McCLANE DLC 70.
 3210' S & 3600' W FROM NE COR. McCLANE DLC 70.

FINAL PROOF SURVEY UNDER

Application No. G-4158 Permit No. G-3910
G-4159 Permit No. G-3911
 IN NAME OF



IVAN MUSTOE

Surveyed Sept 1 1972, by D. Norby