

# T.6N.R.35E.W.M.

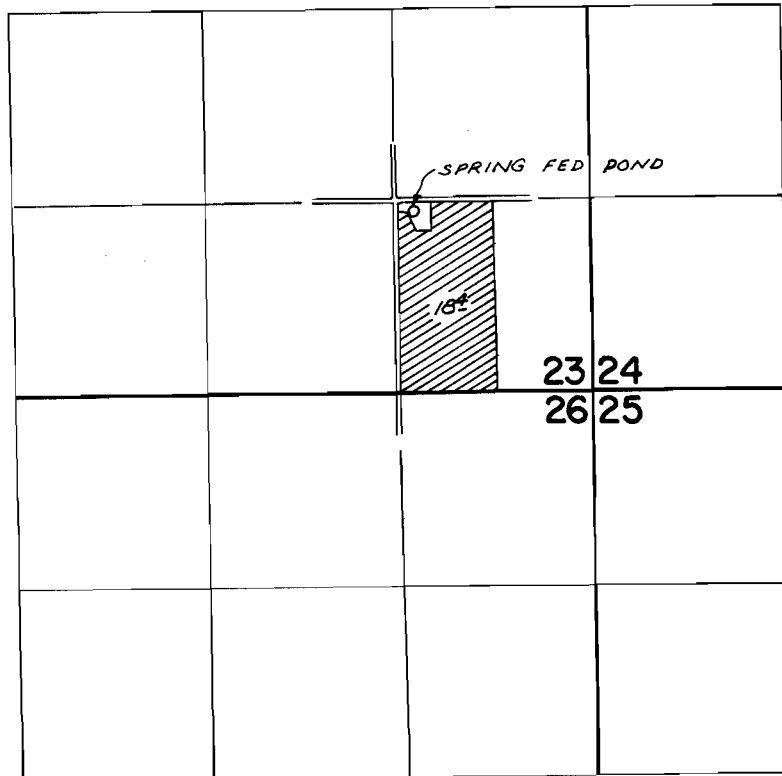

POND LOC: 80'S & 120'E FROM N.W. COR. SE  $\frac{1}{4}$  SE  $\frac{1}{4}$  SEC 23

## FINAL PROOF SURVEY UNDER

Application No. 47952 Permit No. 35951  
IN NAME OF

EMORY CRAWFORD

Surveyed APR. 9, 1973, by R. MUCKEN