

T. 2 S. R. 1 W. W. M.

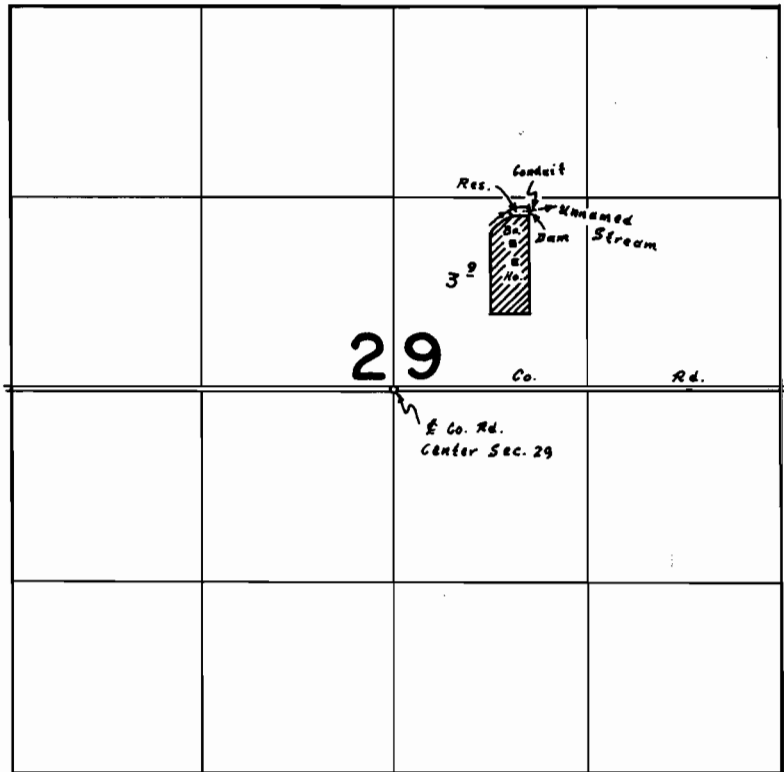

Dam loc. 1230' N. of 930' E. from Center Sec. 29

**FINAL PROOF SURVEY**  
UNDER

R-39003

R-3943

Application No. 39004 Permit No. 29339

IN NAME OF

*Richard Cereghino*

Surveyed 6 Oct. 1972, by L.E. Gould