

T. 19 S. R. 3 W. W.M.

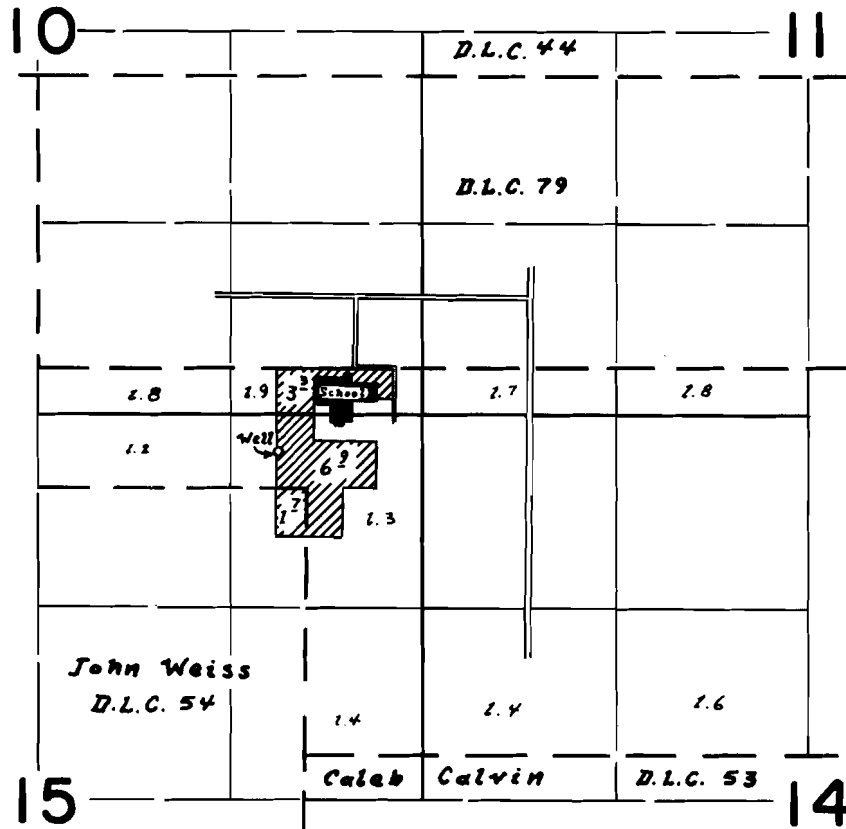

Well loc. 2090' N. & 175' W. from N.W. cor. Caleb Calvin D.L.C. 53

FINAL PROOF SURVEY
UNDER

Application No. G-4454 Permit No. G-3897
IN NAME OF

Alfred C. Johnson

Clerk of School District No. 40

Surveyed 31 MAY 1972, by L.E. Gould