

6-4523  
40978

# T.6N.R.35E.W.M.

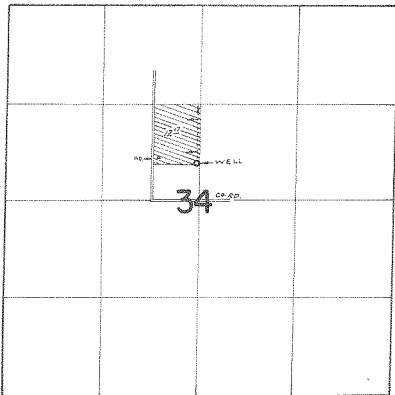

WELL 100' 500' N E 30' W FROM CEN. SEC. 34

## FINAL PROOF SURVEY UNDER

Application No. G-4772 Permit No. G-4523  
IN NAME OF

KYLE H. HUBBS

Surveyed APR. 11, 1973, by R. MUCKEN