

T.5 N. R.27 E. W.M.

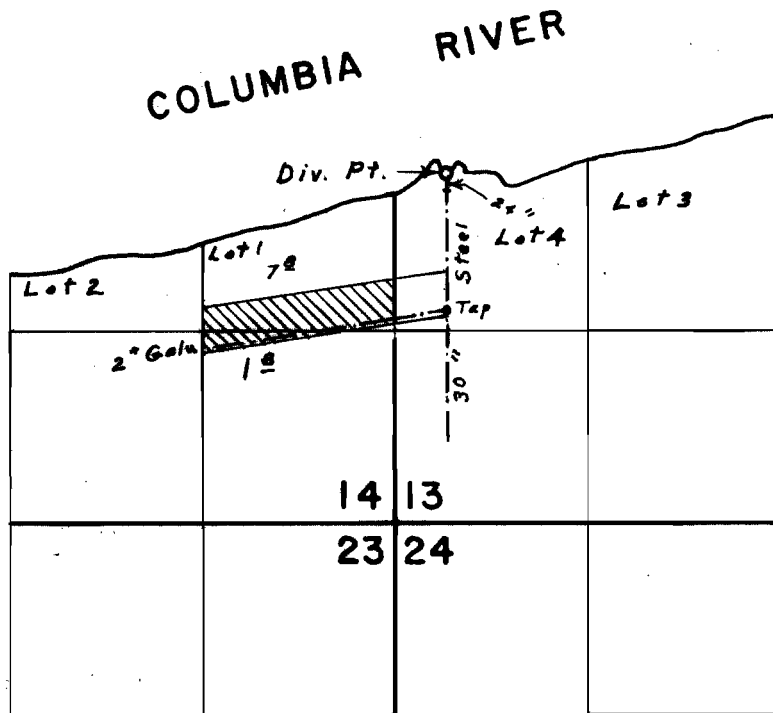

Div. Pt. located 2400' N. & 380' E. from S.W. Cor. Sec. 13

**FINAL PROOF SURVEY**  
UNDER

Application No. 44378 Permit No. 32800  
IN NAME OF

LLOYD H. SAMPSON

Surveyed April 17, 1973, by L. E. Gould