

T.4S. R.2W.W.M.

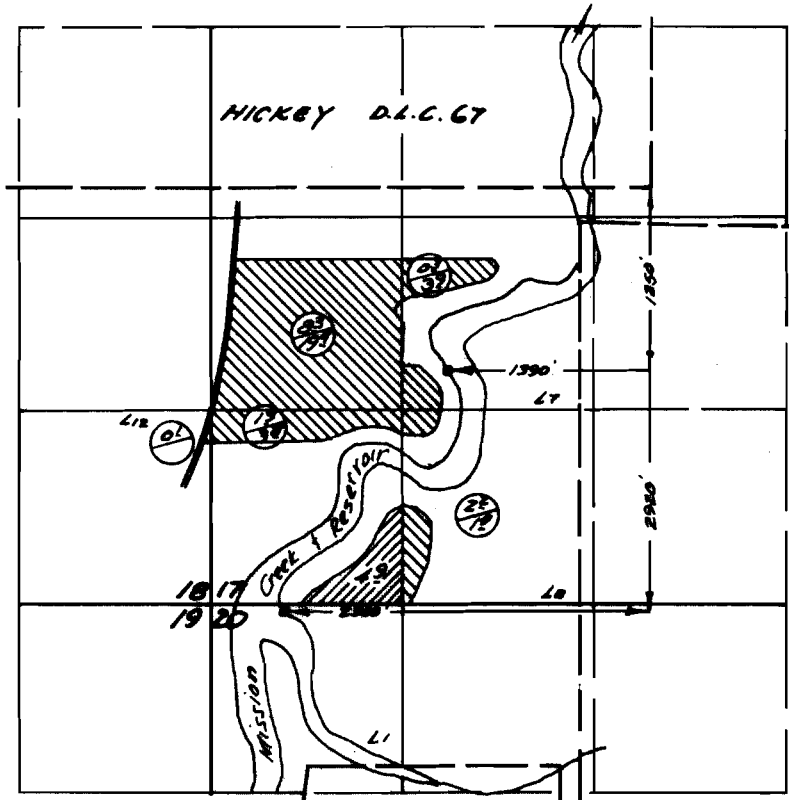

Res. located 107 (248 544) sec. 8 S. 88° W. 380 Ft. from N.W.
Cor. Pettier D.L.C. 98

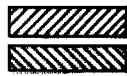

Primary - Creek & Res.
Supplemental - Creek & Res.
Supplemental - Res. only

FINAL PROOF SURVEY
UNDER

Application No. 45263 Permit No. 33225
IN NAME OF

Kirk Bros.

Surveyed Oct. 5, 1972, by D. Nerby