

6-4355  
41021

T.6N. R.35E. W.M.

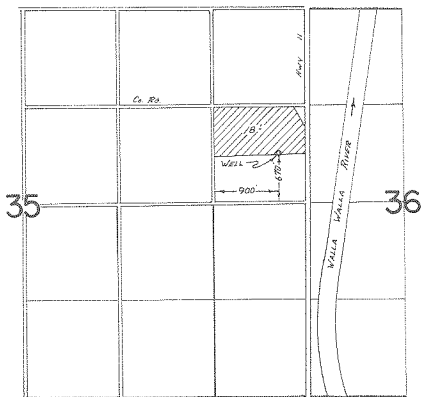

**FINAL PROOF SURVEY**  
UNDER

Application No. G-4430 Permit No. G-4355  
IN NAME OF

WALTER ROLOFF

Surveyed APRIL 12, 1972, by R. G. MUCKEN

TJP  
NZ-SMM-66