

T.2S. R.38E. W.M.

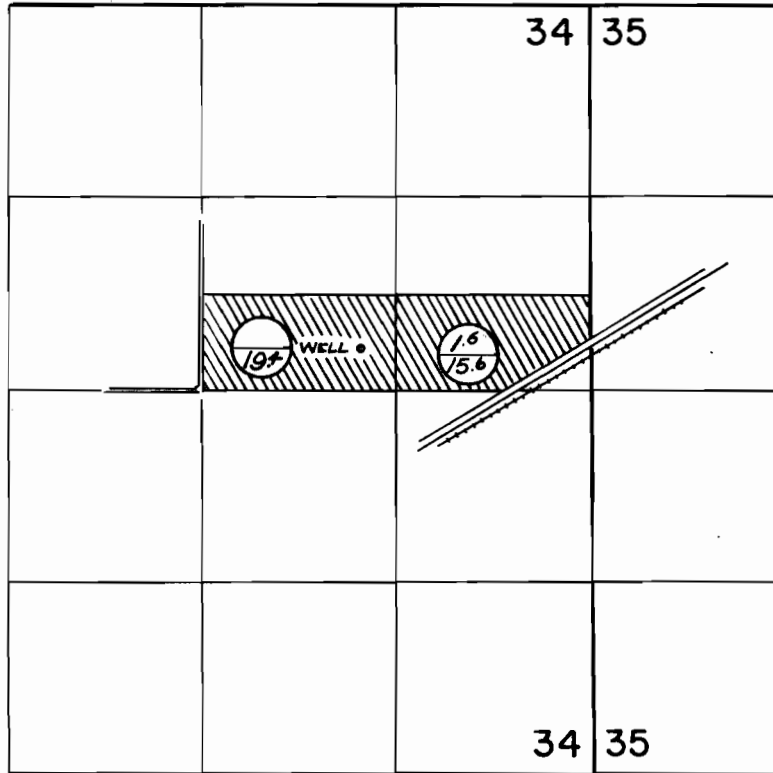

○ PRIMARY
◐ SUPPLEMENTAL

WELL - 300' N., 1090' E. FROM CENTER SECTION 34

FINAL PROOF SURVEY
UNDER

Application No. 6-3702 Permit No. 6-3503

IN NAME OF

CLAUDE E. WRIGHT

Surveyed JULY 16 1973, by R. MUCKEN