

T.1S. R.38E. W.M.

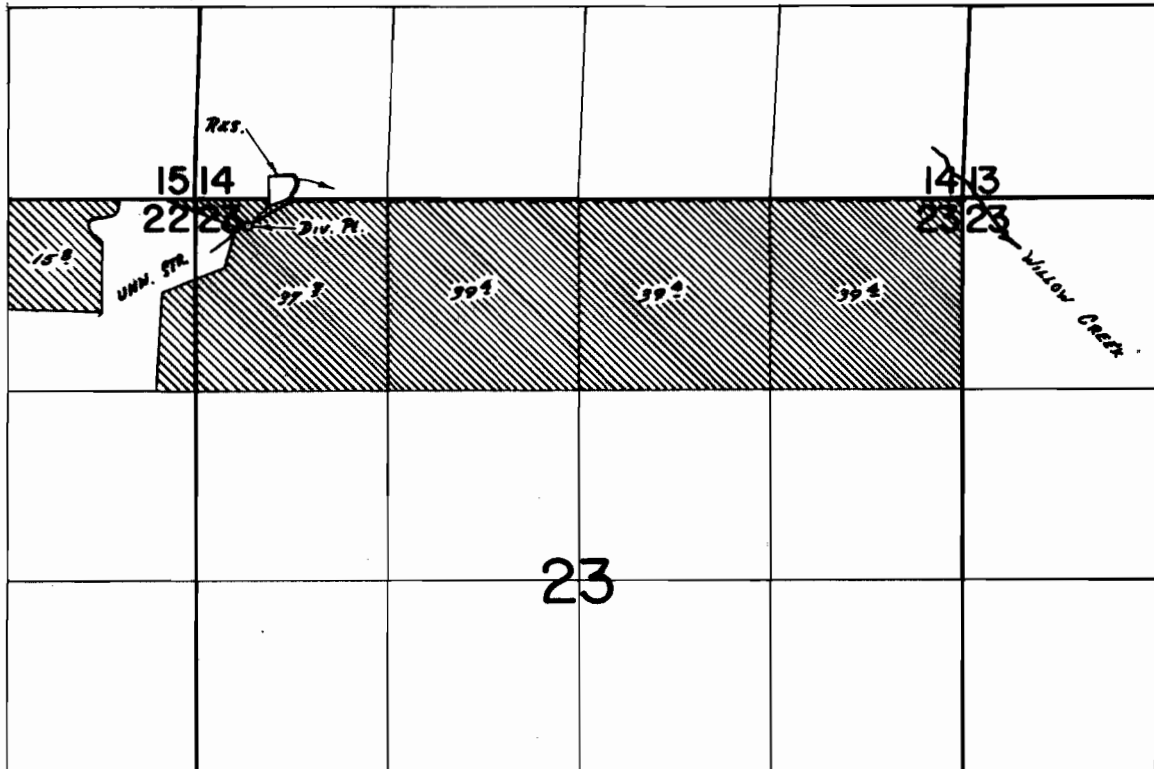

DIV. Pts. LOC. : RES. - 190' N & 2000' E ; UNN. STR. - 180' S & 1640' E FROM NW COR
NE 1/4 NE 1/4 SEC. 22

FINAL PROOF SURVEY
UNDER

R- 45395 R- 5396
Application No. 45396 Permit No. 33786
IN NAME OF

MELVA TAYLOR

Surveyed JULY 10 1973, by R. G. MUCKEN