

T.3N. R.39E. W.M.

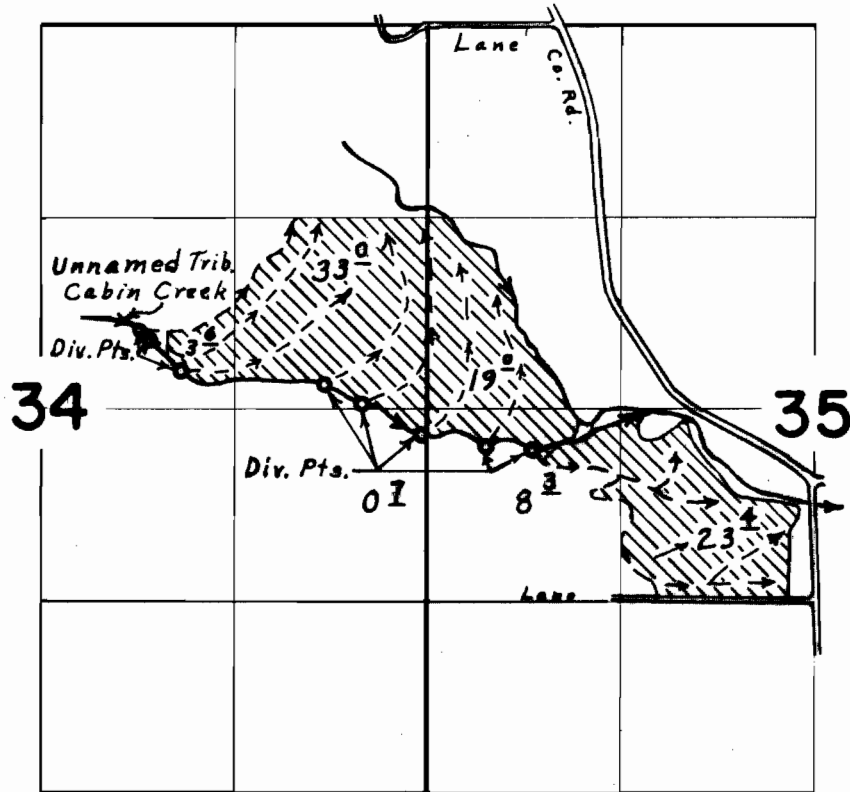

Div. Pts. located: 2000' S. & 1960' W.; 2170' S. & 1890' W.;
2320' S. & 1600' W.; 2470' S. & 690' W.; 2600' S. & 440' W.; 2820' S.
& 30' W.; 2900' S. & 410' E.; 2930' S. & 720' E., all from N.E. Cor. Sec. 34

FINAL PROOF SURVEY
UNDER

Application No. 41342... Permit No. 30868...
IN NAME OF

EMMET L. & THELMA GUISTO

Surveyed Aug. 3... 1973, by L. E. Gould