

T.1S. R.39E. W.M.

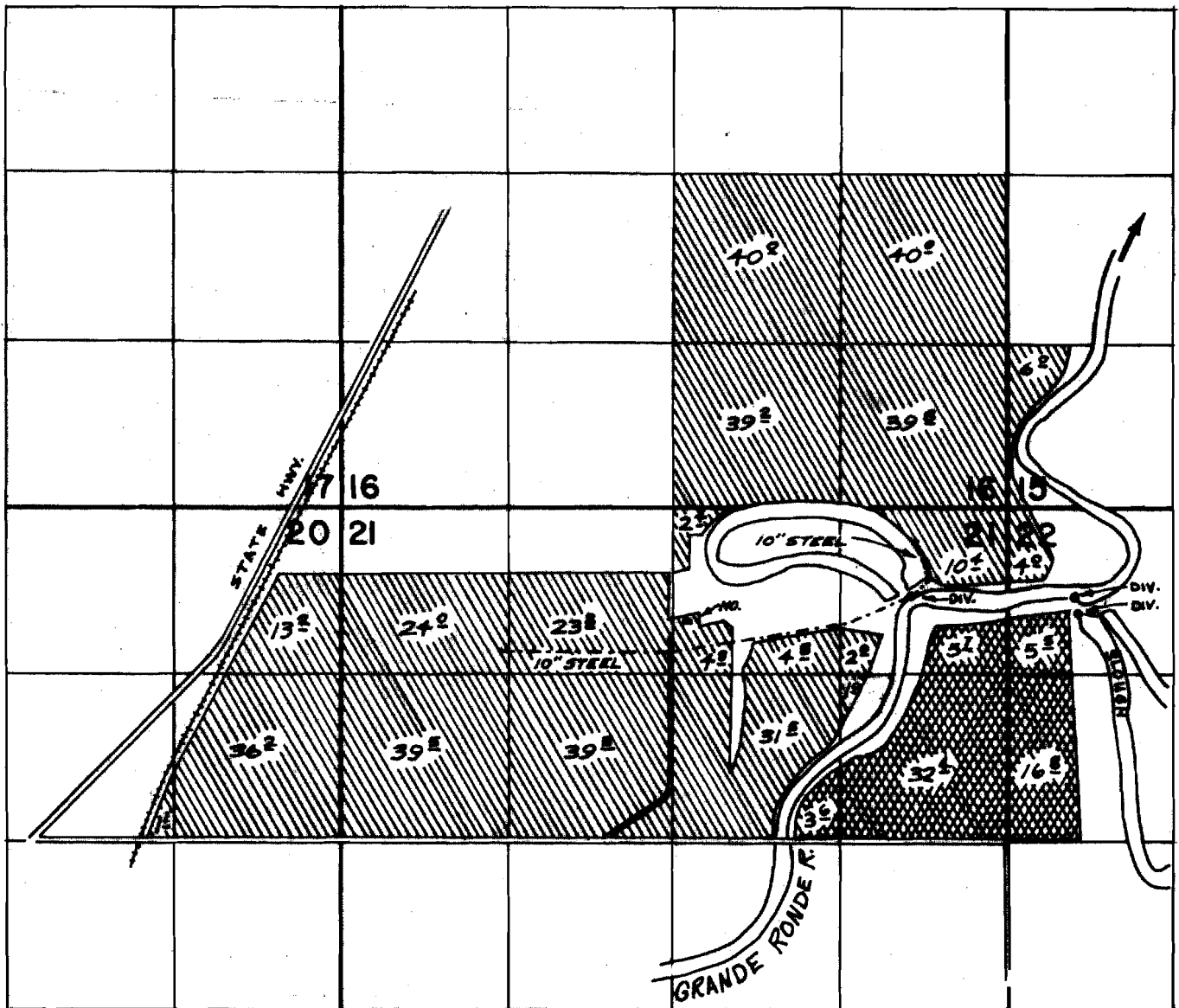

DIV. PTS. 2000'S., 775'W.; 2000'S., 525'E; BOTH FROM NE. COR. SE 1/4 SE 1/4 SEC. 16
 DIV. PT. 2150'S., 550'E FROM N.E. COR. SE 1/4 SE 1/4 SEC. 16

FINAL PROOF SURVEY UNDER

Application No. 42062 Permit No. 31483

Application No. 37462 Permit No. 27890

IN NAME OF

DICK HIBBERD

Surveyed July 14, 1973, by R. MUCKEN

