

T. 2 & 3 S., R. 38 E., W.M.

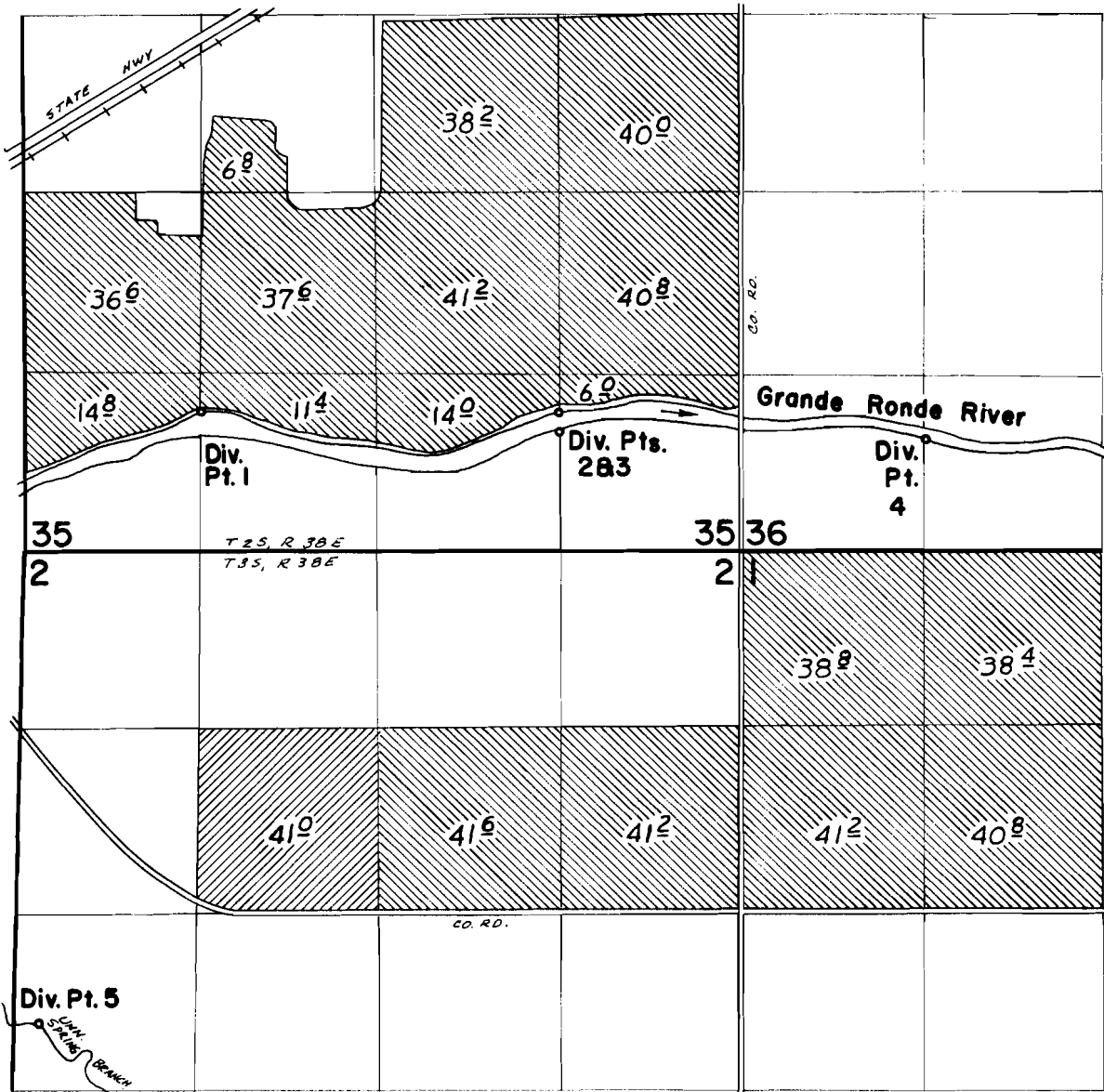

DIV. PTS. LOCATED: 1- 3710' N & 3970' W; 2- 3690' N & 1390' W; 3- 3550' N & 1390' W; 4- 3490' N & 1950' E;
 5- 800' S & 5170' W ALL FROM E 1/4 SECTION 2.

FINAL PROOF SURVEY UNDER

Application No. 45722 Permit No. 34119
 IN NAME OF

JOHN J. SCHROEDER

Surveyed July 11, 1973, by D. Norby