

T.2S. R.39E. W.M.

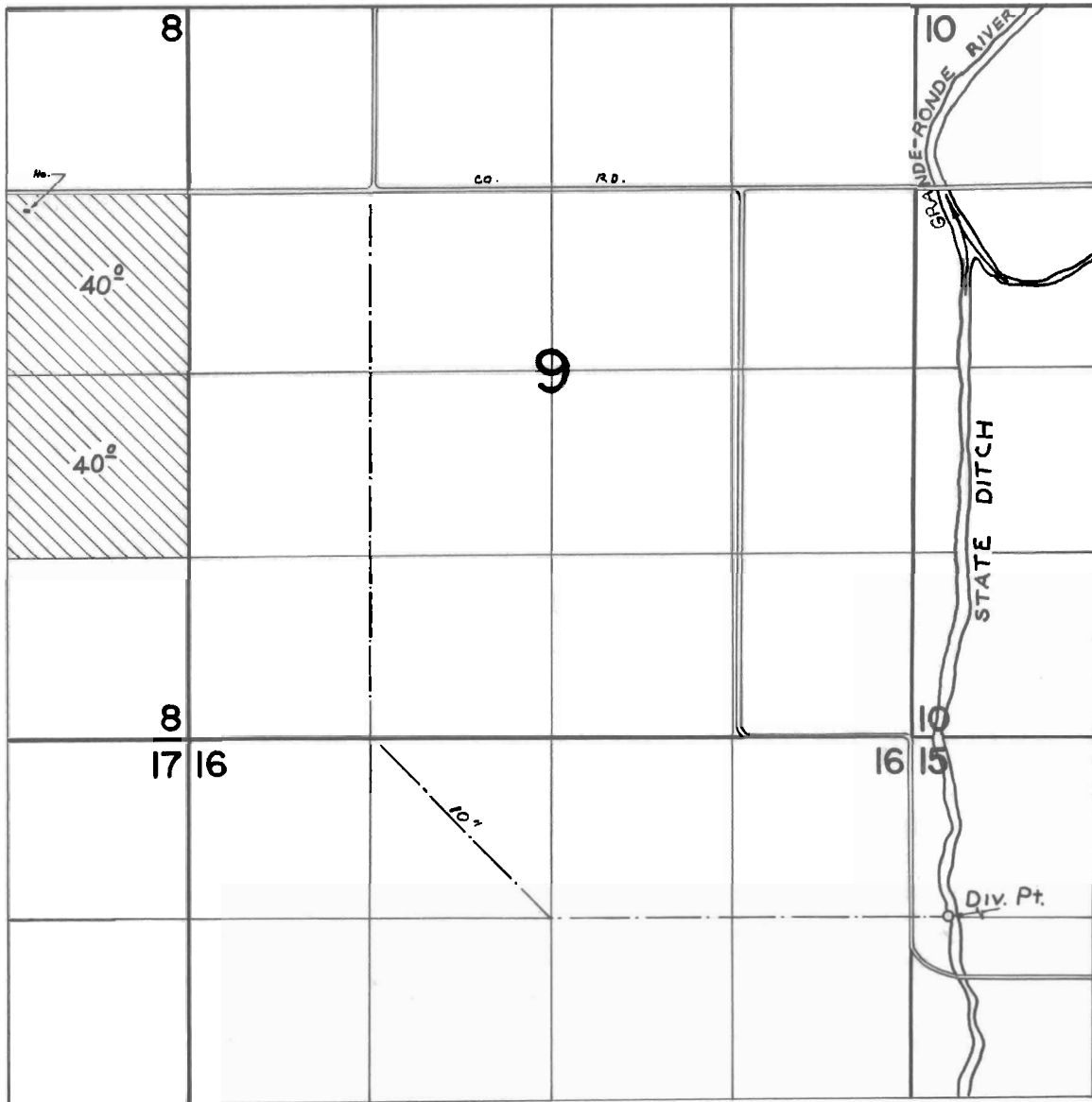

Div. Pt. Loc: 1320' S. & 250' E. from NW cor. Sec. 15

FINAL PROOF SURVEY
UNDER

Application No. 46827 Permit No. 35016
IN NAME OF

CRESTON J. SHAW

Surveyed JULY 16, 1973, by R. MUCKEN