

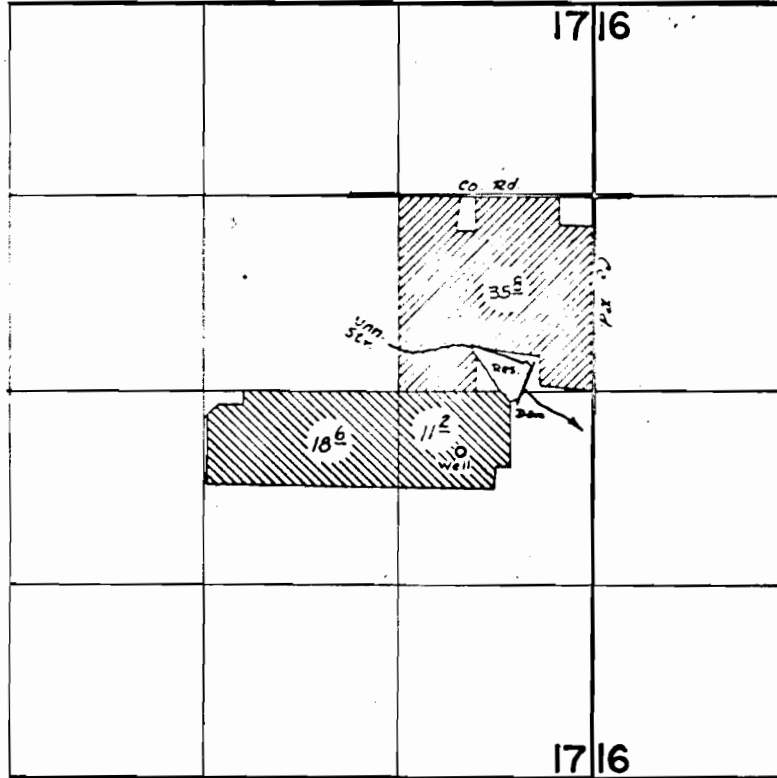

T.1S., R.3W., W.M.



DIV. PT. LOCATED: 1300' S & 480' W FROM SE COR NE $\frac{1}{4}$ NE $\frac{1}{4}$ SEC 17.
WELL LOCATED: 1730' S & 900' W FROM SE COR NE $\frac{1}{4}$ NE $\frac{1}{4}$ SEC 17.

FINAL PROOF SURVEY
UNDER

R-46198 R-5424
46213 34131
Application No. G-4401 Permit No. G-4148 
IN NAME OF

DONALD C. JESSE

Surveyed June 12 1972, by D. Norby