

T.1S., R.3W., W.M.

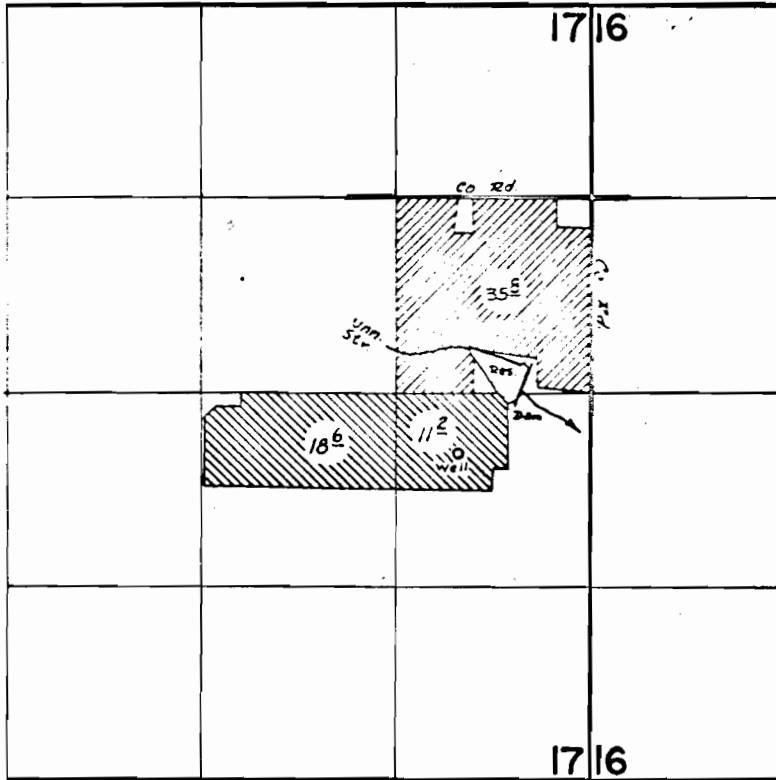

DIP. PT. LOCATED: 1300'S & 480'W FROM SE COR NE $\frac{1}{4}$ NE $\frac{1}{4}$ SEC 17.
 WELL LOCATED: 1730'S & 900'W FROM SE COR NE $\frac{1}{4}$ NE $\frac{1}{4}$ SEC 17.

FINAL PROOF SURVEY UNDER

R-46198 R-5424
 46213 34131
 Application No. G-4401 Permit No. G-4148
 IN NAME OF



DONALD C. JESSE

Surveyed June 12 1972, by D. Norby