

P. 32749

4112

T. 37S.R. 16E.W.M.

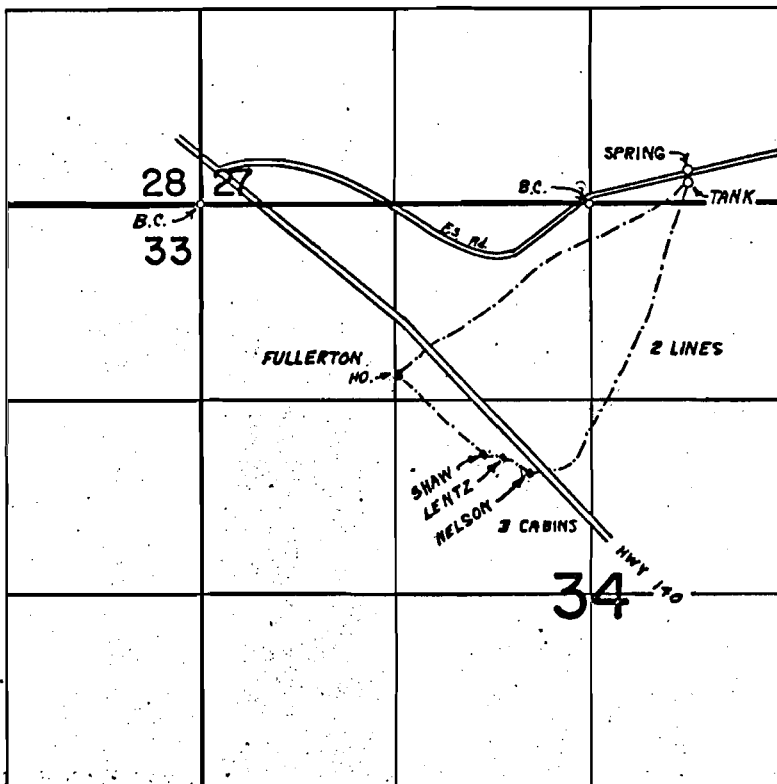

SPRING 250' N & 640' E FROM N 1/4 COR. SEC 34

FINAL PROOF SURVEY UNDER

Application No. 43732 Permit No. 32749
IN NAME OF

Jack Lentz & George W. Fullerton

Surveyed AUG 28 1973, by R.O. MUCKEN