

T. 2S. R. 39E. W. M.

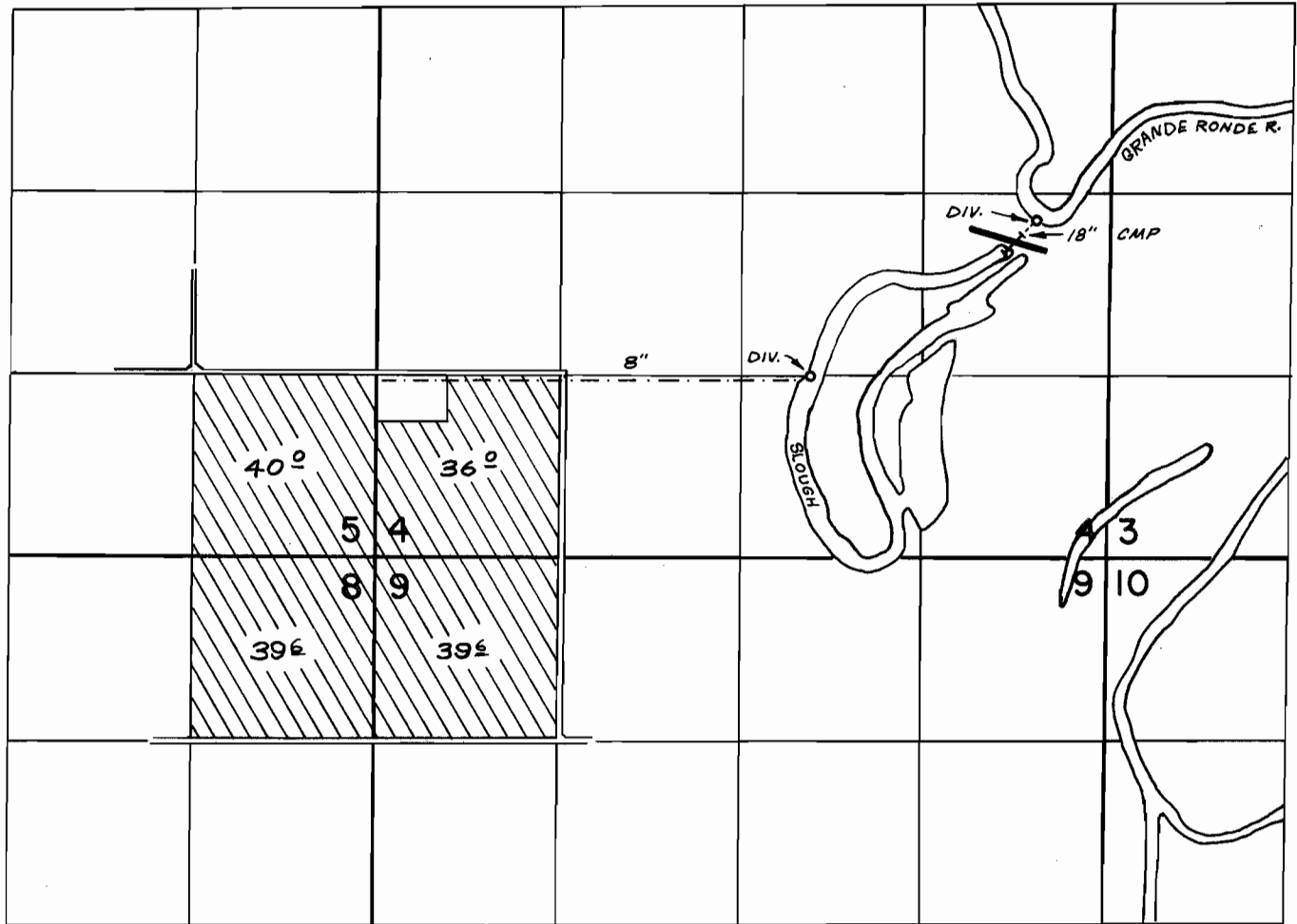

DIV. PTS. ~ 1320' N, 3125' E; 2450' N, 4750' E; BOTH FROM COR. SECTIONS 4, 5, 8, 9

FINAL PROOF SURVEY
UNDER

Application No. 42272 Permit No. 32156
IN NAME OF

ROBERT R. & SHARON K. BECK

Surveyed JULY 16 1973, by R. MUCKEN