

T.IN. R.48E. W.M.

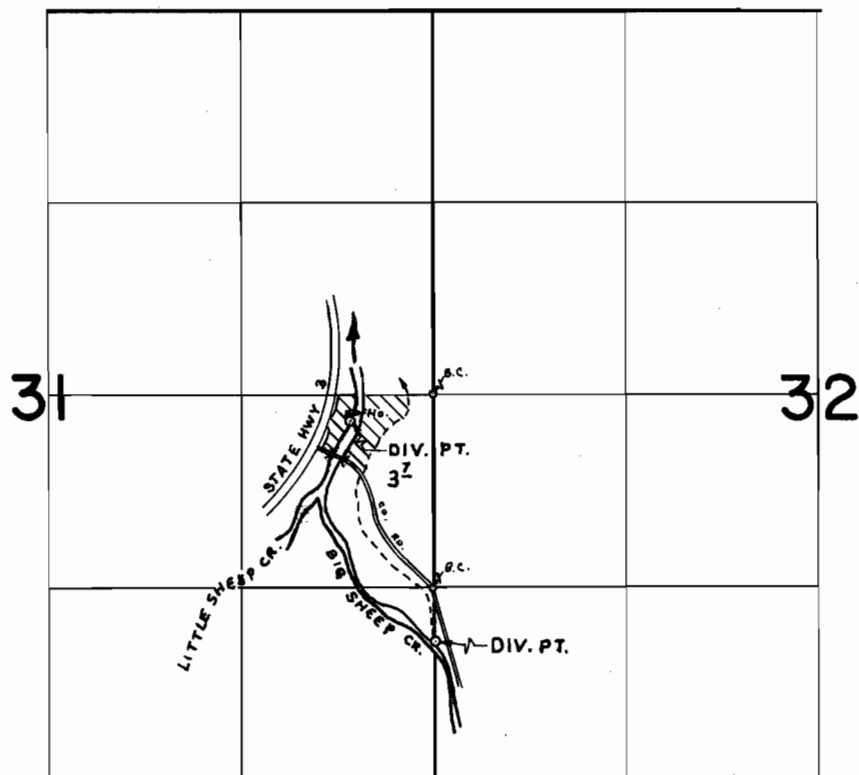

DIV. PTS. LOC: 180'S. E. 570'W., 1700'S. E. 10'E. both from E. 1/4 cor. Sec. 31

FINAL PROOF SURVEY UNDER

Application No. 40549 Permit No. 30221
IN NAME OF

CHAS. H. LYDALL

Surveyed AUG. 6, 1973, by R. MUCKEN