

T.I.S.R.I.W.W.M.

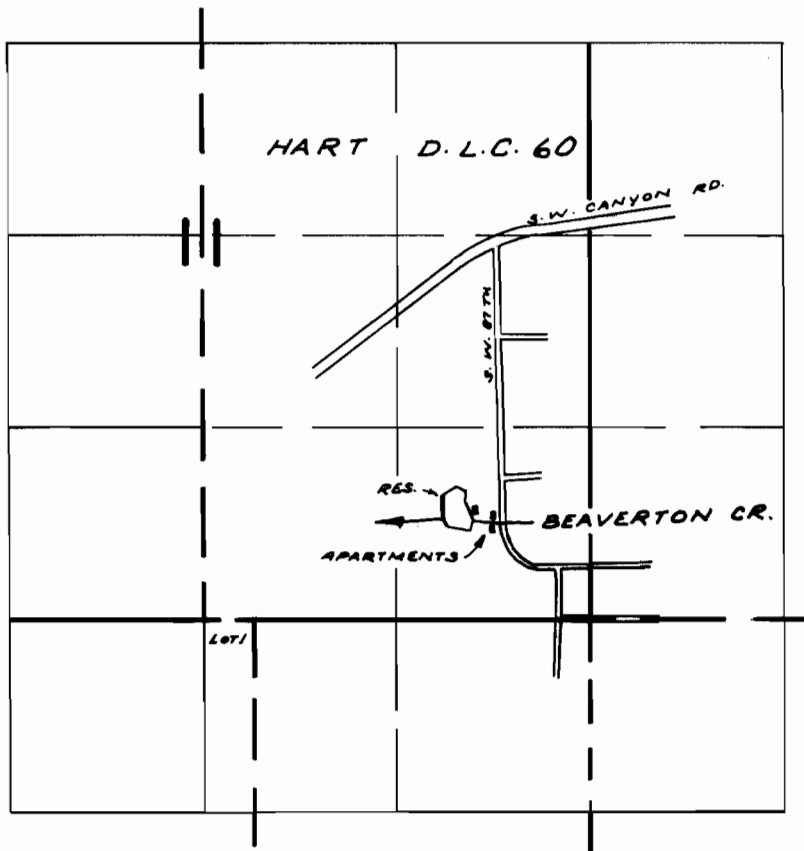

DIV. PT. LOC. 700' N. & 1000' W. FROM S.E. COR. SEC. 11

FINAL PROOF SURVEY UNDER

R-47025 R-5618
Application No. 46804 Permit No. 35000
IN NAME OF

Ernie Piluso

Surveyed Nov. 1, 1972, by R. MUCKEN