

# T.I.S.R.I.W.W.M.

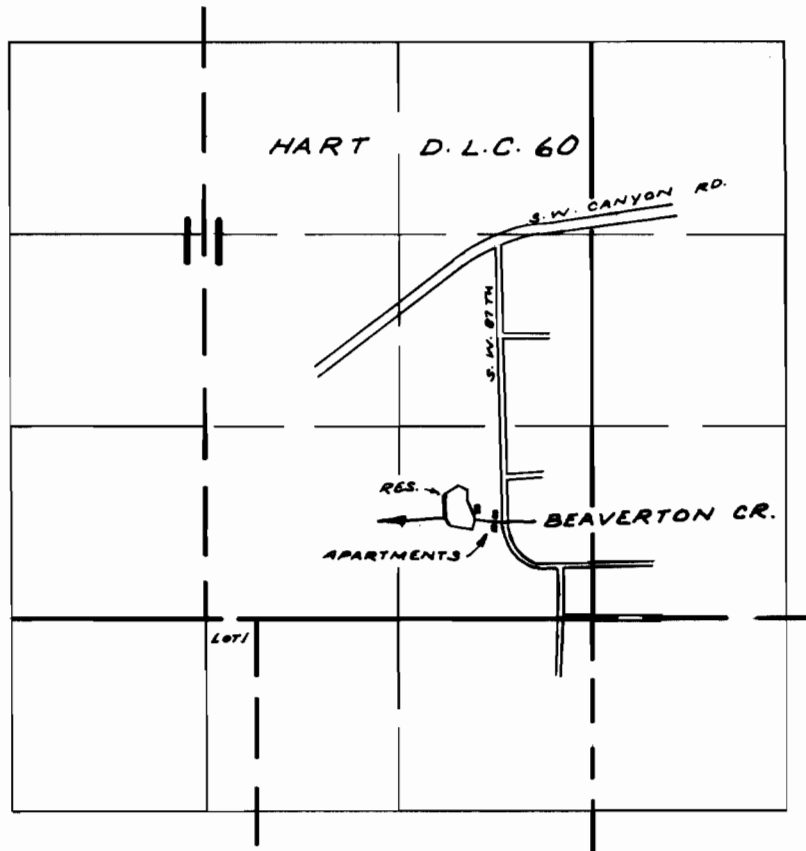

DIV. PT. LOC: 700' N. E 1000' W. FROM S.E. COR. SEC. 11

## FINAL PROOF SURVEY UNDER

Application No. R-47025 46804 Permit No. R-5618 35000  
IN NAME OF

Ernie Piluso

Surveyed NOV. 1, 1972, by R. MUCKEN