

T.38S.,R.3W.,W.M.

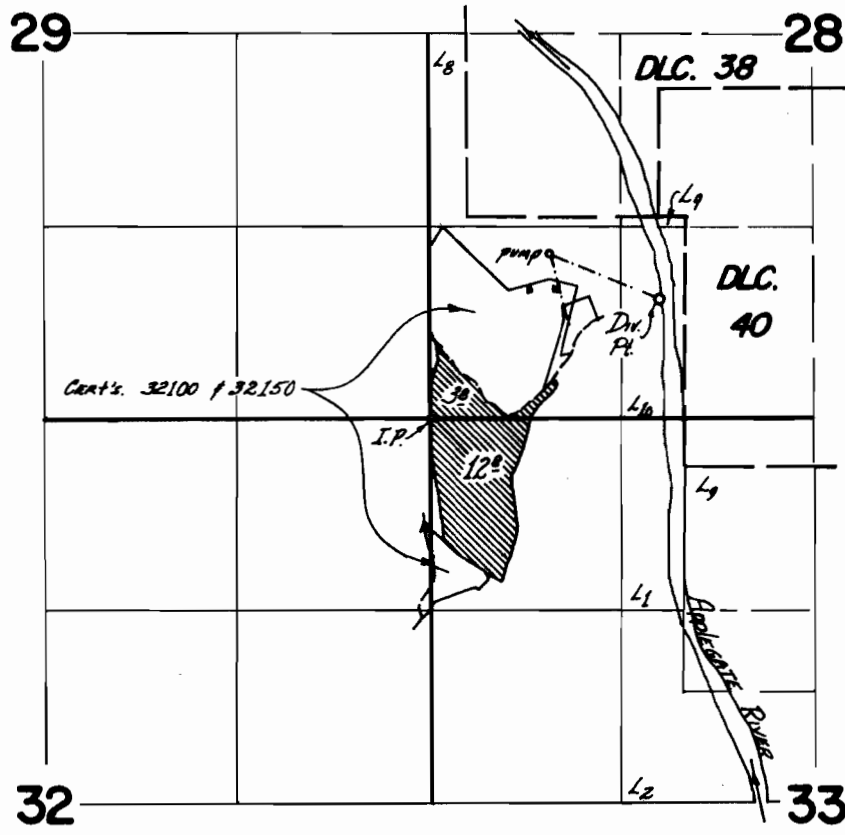

Dir. Pt. loc: 820' N. of 1580' E. from SW cor. Sec. 28

**FINAL PROOF SURVEY**  
UNDER

Application No. 43265 Permit No. 32339  
IN NAME OF

MARION DUNLAP

Surveyed Oct. 18 1973, by D. NORBY