

T. 36 S.R. 4 W.W.M.

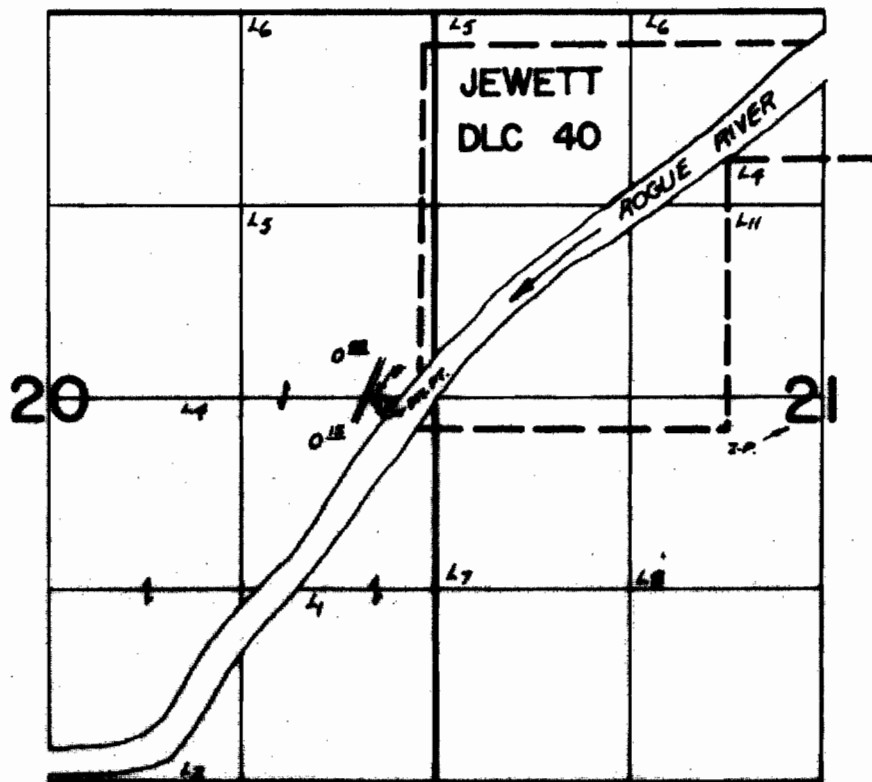

BY PT. 100' S & 2000' W FROM CEN. SEC. 21

FINAL PROOF SURVEY
UNDER

Application No. 45716 Permit No. 34103
IN NAME OF

GUY E. & JENNIE BLUM

Surveyed OCT 13 1973, by R.G. MUCKEN