

T.35S. R.3W. W.M.

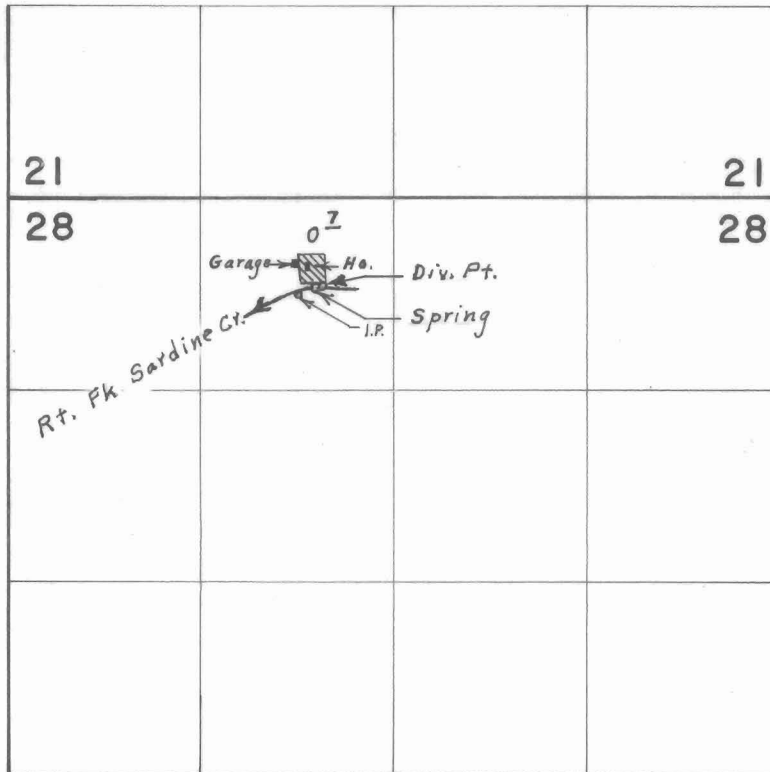

Div. Pts. located: Spr., 610' S. & 530' W., Str., 600' S. & 500' W., both from N. & Cor. Sec. 28

FINAL PROOF SURVEY UNDER

Application No. 46118 Permit No. 34455
IN NAME OF

NADINE DEAL

Surveyed Oct. 2. 1973., by L. E. Gould