

T2S.,R.44E.,W.M.

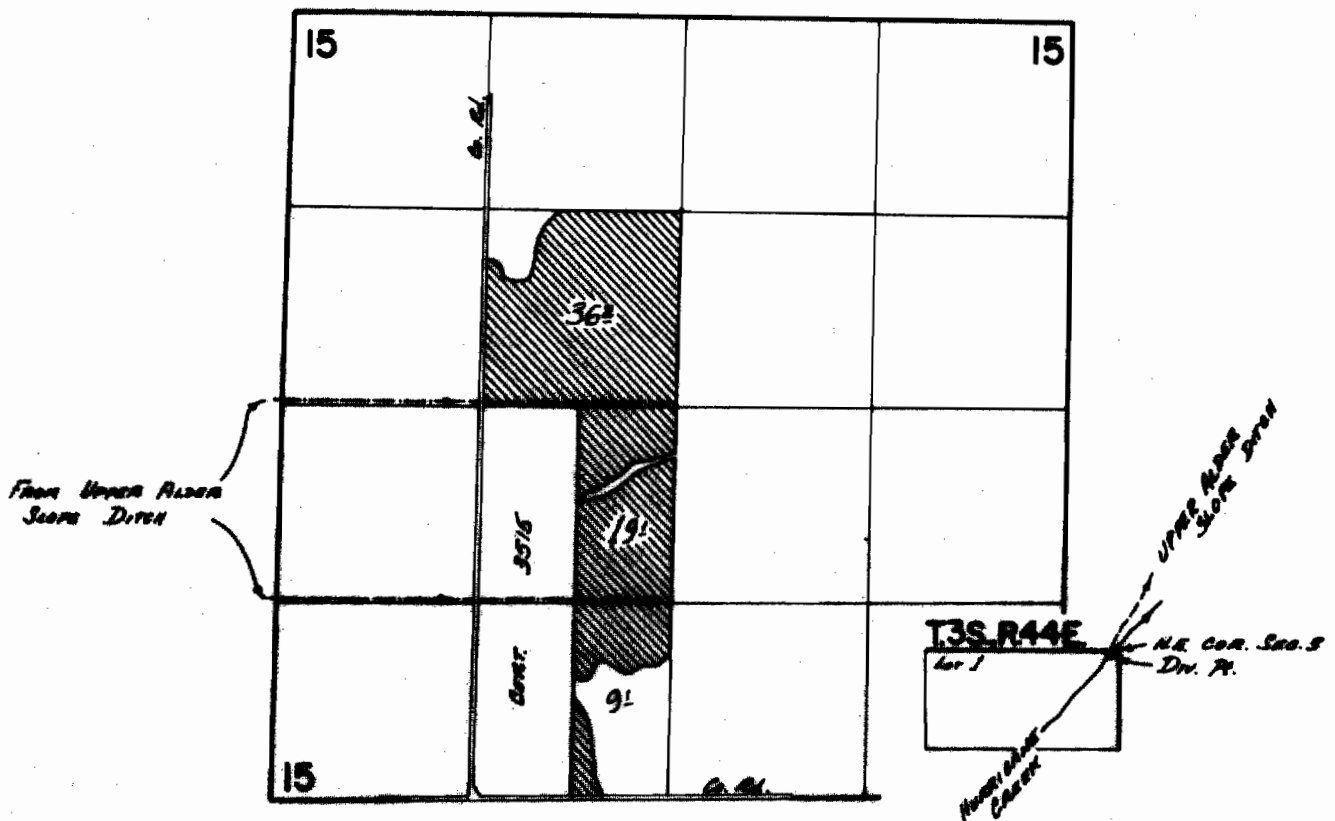

Div. Pt. Loc: S 76° 08' W 49' FROM NE COR. SEC. 3, T.3S., R.44E.

FINAL PROOF SURVEY
UNDER

Application No. 45750 Permit No. 34149
IN NAME OF

ARNOLD I. JUVE

Surveyed Aug. 11, 1913, by D. Norway