

T.I.S.R.44E.W.M.

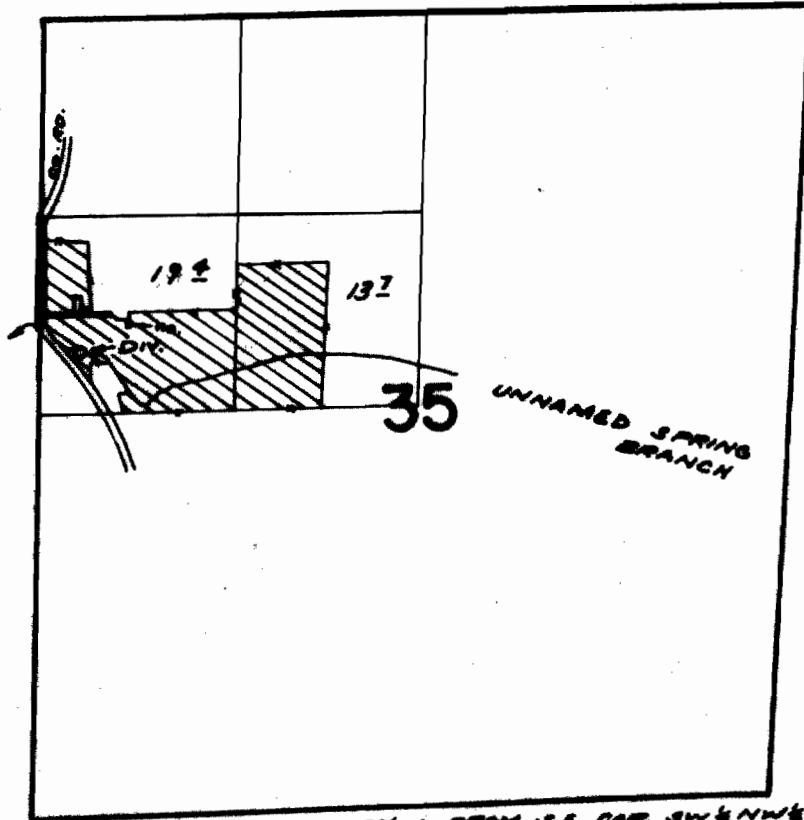

DIV. PT. LOC: 430' N & 1030' W. FROM S.E. COR. SW 1/4 NW 1/4  
SEC. 35

**FINAL PROOF SURVEY**  
UNDER

Application No. 15756 Permit No. 34152  
IN NAME OF

.....WAYNE LATHROP.....

Surveyed AUG. 1 1973, by R. MUCKEN