

T.3N., R.11E., W.M.

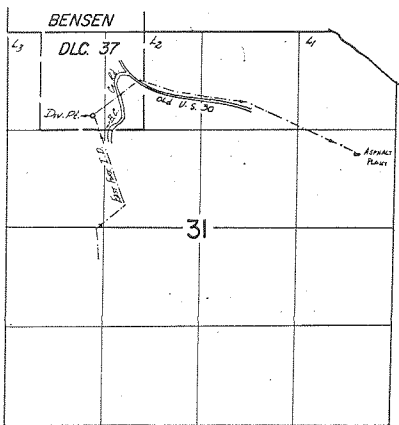

Div. Pt. loc. 180' N. of 160' W. from SE cor. NW $\frac{1}{4}$ NW $\frac{1}{4}$ Sec. 31

FINAL PROOF SURVEY
UNDER

Application No. 49029 Permit No. 36694
IN NAME OF

J. ARLIE BRYANT, INC.

Surveyed Aug. 31, 1972, by D. NORBY