

T.6S.,R.10W.,W.M.

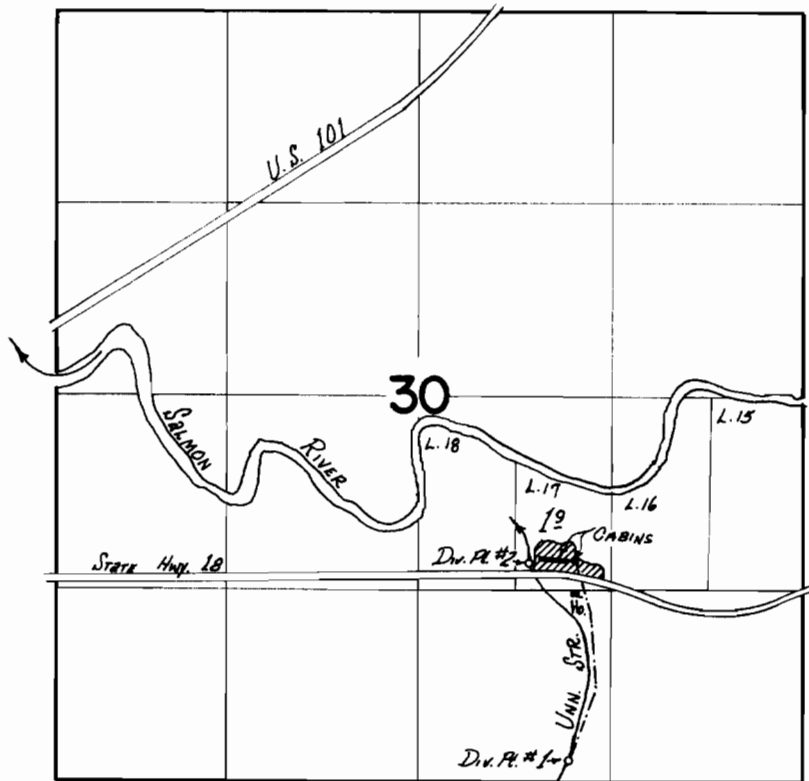

Div. Pts. Loc.: #1-140' N. of 1040' E.; #2-1490' N. of 750' E.; BOTH FROM S. 1/4 COR. SEC. 30.

FINAL PROOF SURVEY
UNDER

Application No. 41614 Permit No. 31032
IN NAME OF

GUS & GERALDINE RUSSELL

Surveyed SEPT. 5 1973, by D. Noray