

T.38S.,R.3W.,W.M.

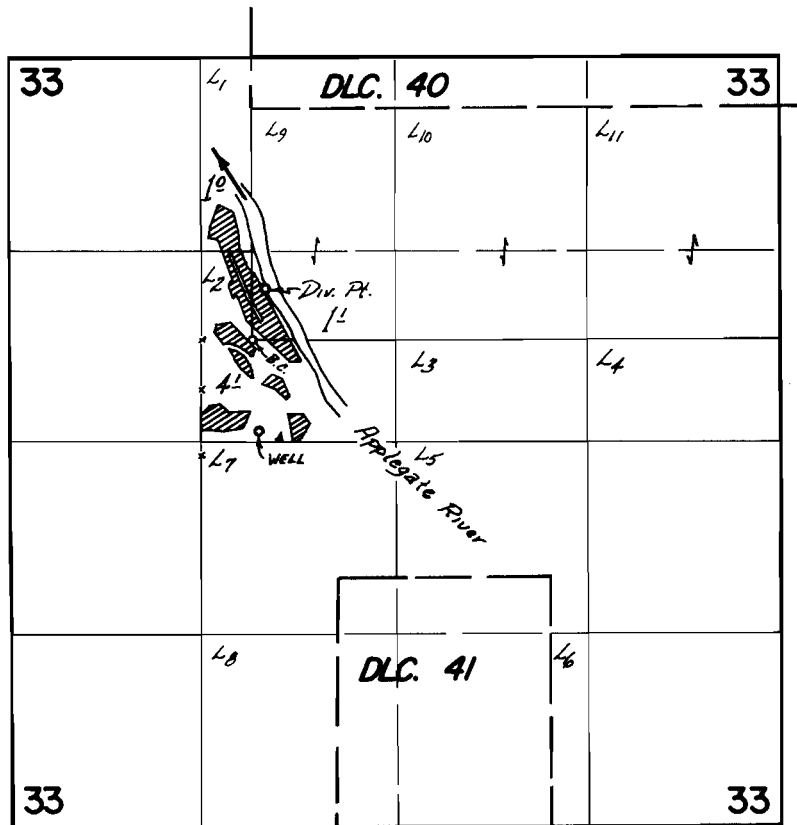

Div. Pts. loc: River - 350' N. of 80' E.; Well - 630' S. of 40' E.; both from SW cor. Lot 9, Sec. 33.

**FINAL PROOF SURVEY**  
UNDER

Application No. 42700 Permit No. 31905  
G-4505 G-4247  
IN NAME OF

Jackson County Parks & Recreation

Surveyed Oct. 16 1973, by D. NORBY