

T.I.S. R.3 E. W.M.

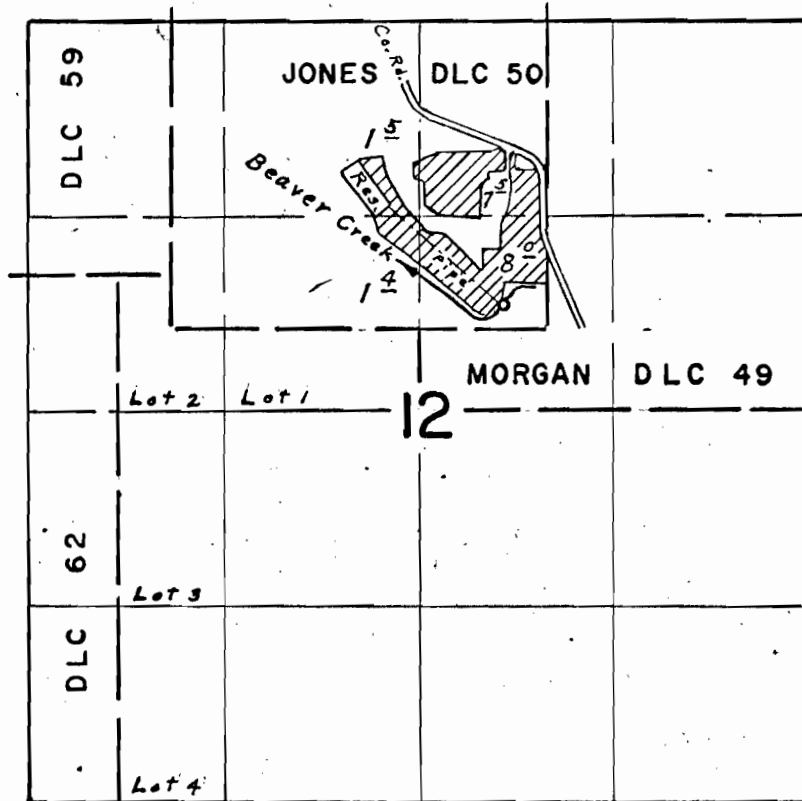

Div. Pts. located: Cr., 1920' S. & 3220' E.; Res., 1150' S.
& 2300' E., both from N.W. Cor. Sec. 12.

FINAL PROOF SURVEY UNDER

R-43820 R-5038
Application No. 44190 Permit No. 32796
IN NAME OF

KAZUMA J. TAMURA

Surveyed Sept. 10, 1973, by L. E. Gould