

T.I.S. R.4 E. W.M.

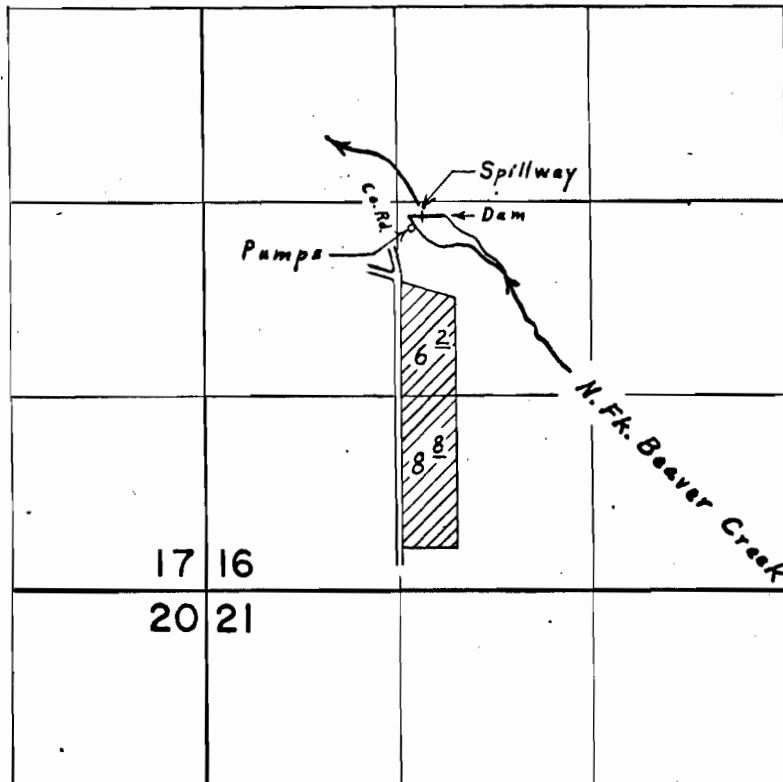

Div. Pt. loc. 2530' N. & 1480' E. from S. W. Cor. Sec. 16

**FINAL PROOF SURVEY**  
UNDER

R-45132 R-5288  
Application No. 44842 Permit No. 33485  
IN NAME OF

GLENDAL FARM INC.

Surveyed Sept. 12, 1973, by L. E. Gould