

T.1 S. R.4 E. W.M.

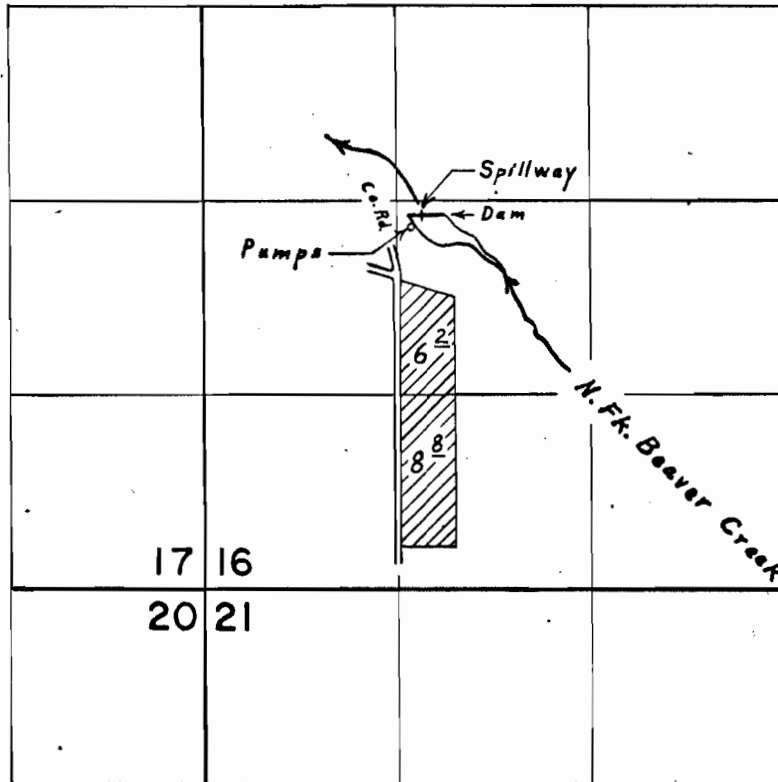

Div. Pt. loc. 2530' N. & 1480' E. from S.W. Cor. Sec. 16

FINAL PROOF SURVEY
UNDER

R-45 132 R-5288
Application No. 44842 Permit No. 33485
IN NAME OF

LENDALE FARMS INC.

Surveyed Sept. 12, 1973, by L. E. Gould.